

INSTALLATION & OPERATION MANUAL

SEE-THRU MODELS: BI-48-ST, BI-60-ST, BI-72-ST

SINGLE SIDE MODELS: BI-48-SSL, BI-48-SSR, BI-60-SSL, BI-60-SSR, BI-72-SSL, BI-72-SSR

▲ WARNING

FIRE OR EXPLOSION HAZARD

Failure to follow safety warnings exactly could result in serious injury, death, or property damage.

- Do not store or use gasoline or other flammable vapors and liquids in the vicinity of this or any other appliance.
- **WHAT TO DO IF YOU SMELL GAS**
 - Do not try to light any appliance.
 - Do not touch any electrical switch; do not use any phone in your building.
 - Immediately call your gas supplier from a neighbor's phone. Follow the gas supplier's instructions.
 - If you cannot reach your gas supplier, call the fire department.
- Installation and service must be performed by a qualified installer, service agency or the gas supplier.

DUE TO HIGH TEMPERATURES, THE APPLIANCE SHOULD BE LOCATED OUT OF TRAFFIC AND AWAY FROM FURNITURE AND DRAPERIES.

CHILDREN AND ADULTS SHOULD BE ALERTED TO THE HAZARD OF HIGH SURFACE TEMPERATURE AND SHOULD STAY AWAY TO AVOID BURNS OR CLOTHING IGNITION.

YOUNG CHILDREN SHOULD BE CAREFULLY SUPERVISED WHEN THEY ARE IN THE SAME ROOM WITH THE APPLIANCE.

DO NOT PLACE CLOTHING OR OTHER FLAMMABLE MATERIAL ON OR NEAR THE APPLIANCE.

WARNING Improper installation, adjustment, services or maintenance can cause injury, or property damage. Refer to this manual. For assistance or additional information, consult a qualified installer, service agency, or gas supplier.

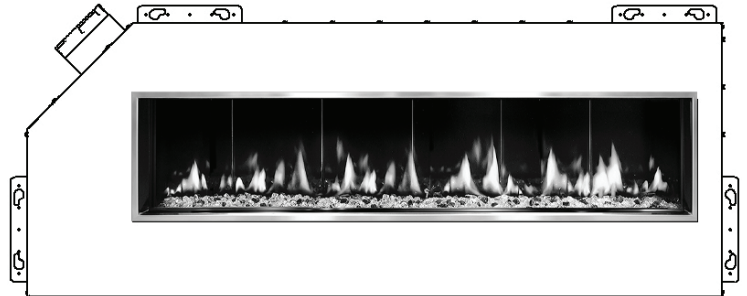

Ce manuel est disponible en Francais sur demande.

This appliance may be installed in an aftermarket, permanently located, manufactured home (USA only) or mobile home, where not prohibited by local codes.

This appliance is only for use with the type of gas indicated on the rating plate. This appliance is not convertible for use with other gases, unless a certified kit is used.



DANGER



**HOT GLASS
WILL CAUSE BURNS.**

**DO NOT TOUCH GLASS
UNTIL COOLED.**

**NEVER ALLOW CHILDREN
TO TOUCH GLASS.**

A barrier designed to reduce the risk of burns from the hot viewing glass is provided with this appliance and must be installed for the protection of children and other at-risk individuals.

INSTALLATION RECORD

SÓLAS

The installer should complete the form below that describes the details of the installation. Having this written record of installation information available will greatly expedite troubleshooting should any problem arise with your stove. The installer should keep a duplicate of this form for their records.

Date Purchased: _____

Dealer: _____

Date Installed: _____

Installer: _____

Fireplace Model: (circle one) **FORTY8** **SIXTY0** **SEVENTY2**

Serial Number: _____

Brand of Venting Used: _____

Model # of Vent Cap Used: _____

Fuel: (circle one) **Natural Gas (NG)** **Propane (LP)**

Was this field converted? (circle one) YES NO

Inlet Pressure (after installation): _____

Manifold Pressure (after Installation): High Fire: _____ in. WC

Low Fire: _____ in. WC

Altitude: (feet above sea level) _____

Was the Fireplace derated? (circle one) YES NO

If the Fireplace was derated, to what orifice size? _____

Other installation notes: _____

CONTENTS

Installation Record	2
Important Safety Information.....	5
Model Descriptions.....	7
Certification.....	8
Specifications	9
Clearances	11
Installation Information	14
Electrical & Plumbing Info	15
Comfort Blower Info	16
Venting.....	19
Final Assembly.....	26
Lighting & Operation	30
Remote Operation.....	32
Gas Conversion	40
Maintenance	44
Battery Replacement.....	45
Maintenance Log.....	46
Replacement Parts List	47
Control Schematic.....	48
Warranty Information	49

Congratulations on your purchase of a SÓLAS Fireplace!

We welcome you to the SÓLAS family of gas fireplaces. Each of our products are skillfully designed and expertly manufactured in the USA. We take great pride in every fireplace we make. Each product is fully tested throughout the production process to ensure your safety and warmth throughout the years.

Sincerely,
The SÓLAS Team

WE STRONGLY SUGGEST THAT YOU READ THIS MANUAL THOROUGHLY BEFORE BEGINNING THE INSTALLATION OF THIS DIRECT VENT GAS FIREPLACE. ALTHOUGH THE BASIC REQUIREMENTS FOR THE INSTALLATION OF ALL DIRECT VENT GAS FIREPLACES ARE SIMILAR, EACH SPECIFIC PRODUCT HAS ITS OWN UNIQUE SET-UP AND INSTALLATION REQUIREMENTS THAT MUST BE FOLLOWED EXACTLY. PLAN YOUR INSTALLATION IN ADVANCE BY CAREFULLY REVIEWING ALL THE INFORMATION CONTAINED IN THIS MANUAL.

The information contained in this manual is believed to be correct at the time of printing. SÓLAS LLC reserves the right to change or modify any information or specifications without notice. SÓLAS LLC grants no warranty, implied or stated, for the installation or maintenance of your appliance, and assumes no responsibility for any consequential damage(s).
© 2022 Copyright SÓLAS LLC.

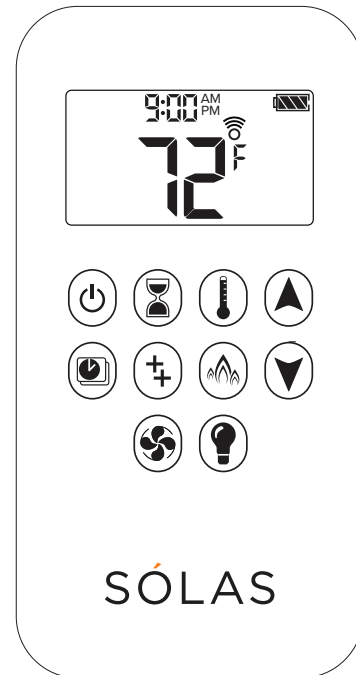

**SÓLAS One-Touch
Programmable Thermostatic Remote**
(see page 34)

Félicitations pour votre achat d'un SÓLAS !

Nous vous souhaitons la bienvenue dans la famille des foyers au gaz SÓLAS. Chacun de nos produits est habilement conçu et fabriqué de manière experte aux États-Unis. Nous sommes très fiers de chaque foyer que nous fabriquons. Chaque produit est entièrement testé tout au long du processus de production pour garantir votre sécurité et votre chaleur au fil des ans.

Sincèrement,

SÓLAS

AVERTISSEMENT: Assurez vous de bien suivre les instructions données dans cette notice pour réduire e au minimum le risque d'incendie ou d'explosion ou pour éviter tout dommage matériel, toute blessure ou la mort.

Ne pas entreposer ni utiliser d'essence ni d'autres vapeurs ou liquids inflammables dans le voisinage de cet ap pareil ou de tout autre appareil.

— QUE FAIRE SI VOUS SENTEZ UNE ODEUR DE GAZ:

- Ne pas tenter d'allumer d'appareil.
- Ne touchez à aucun interrupteur. Ne pas vous servir des téléphones se trouvant dans le bâtiment où vous trouvez.
- Appelez immédiatement votre fournisseur de gaz depuis un voisin. Suivez les instructions du fournisseur.
- Si vous ne pouvez rejoindre le fournisseur de gaz, appelez le service des incendies.

— L'installation et l'entretien doivent être assurés par un installateur ou un s ervice d'entretien qualifié ou par le fournisseur de gaz.

Cet appareil peut être installé dans une maison préfabriquée (mobile) déjà installée à demeure si les règlements locaux le permettent.

Cet appareil doit être utilisé uniquement avec les types de gaz indiqués sur la plaque signalétique. Cet appareil ne peut être converti à d'autres gaz, sauf si une trousse de conversion est utilisée.

Ne pas utiliser cet appareils il a été plongé, même partiellement, dans l'eau. Appeler un technicien qualifié pour inspecter l'appareil et remplacer toute partie du système de commande et toute commande qui a été plongée dans / 'eau.

ATTENTION: Au moment de l'entretien des commandes, étiquetez tous les fils avant de les débrancher. Des erreurs de la câblage peuvent entraîner un fonctionnement inadéquate et dangereux.

S'assurer que l'appareil fonctionne adéquatement une fois l'entretien terminé.

ATTENTION: Ne pas utiliser l'appareil si la panneau frontal en verre n'est pas en place, est craqué ou brisé. Confiez le remplacement du panneau à un technicien agréé.

**INSTALLATEUR: LAISSEZ CE MANUEL AVEC L'APPAREIL.
CONSOMMATEUR: CONSERVEZ CE MANUEL AUX FINS DE CONSULTATION ULTÉRIEURE.**

IMPORTANT SAFETY INFORMATION

The installation must conform with local codes or, in the absence of local codes, with the National Fuel Gas Code, ANSI Z223.1/NFPA 54, or the Natural Gas and Propane Installation Code, CSA B149.1.

A manufactured home (USA only) or mobile home OEM installation must conform with the Manufactured Home Construction and Safety Standard, Title 24 CFR, Part 3280 or when such a standard is not applicable, the Standard for Manufactured Home Installations, ANSI/BCSBCS A225.1, or Standard for Gas Equipped Recreational Vehicles and Mobile Housing, CSA Z240.4.

The appliance and its appliance main gas valve must be disconnected from the gas supply piping system during any pressure testing of that system at test pressures in excess of ½ psi (3.5 kPa).

The appliance must be isolated from the gas supply piping system by closing its equipment shutoff valve during any pressure testing of the gas supply piping system at test pressures equal to or less than ½ psi (3.5 kPa).

The installation must provide for adequate ventilation air to the appliance.

This gas appliance must not be connected to a chimney flue serving a separate solid-fuel burning appliance.

The appliance, when installed, must be electrically grounded in accordance with local codes, or, in the absence of local codes, with the National Electrical Code ANSI/NFPA 70, or the Canadian Electrical Code, CSA C22. 1.

The appliance area must be kept clear and free from combustible materials, gasoline and other flammable vapors and liquids.

The flow of combustion and ventilation air must not be obstructed. Adequate accessibility clearances must be maintained for servicing and proper operation of this appliance.

Do not use this appliance if any part has been under water. Immediately call a qualified service technician to inspect the appliance and to replace any part of the control system and any gas control which has been under water.

Due to high temperatures, the appliance should be located out of traffic and away from furniture and draperies.

Children and adults should be alerted to the hazards of high surface temperatures and should stay away to avoid burns or clothing ignition.

Young children should be carefully supervised when they are in the same room as the appliance. Toddlers, young children and others may be susceptible to accidental contact burns. A physical barrier is recommended if there are at-risk individuals in the house. To restrict access to a fireplace or stove, install an adjustable safety gate to keep toddlers, young children and other at-risk individuals out of the room and away from hot surfaces.

A barrier designed to reduce the risk of burns from the hot viewing glass is provided with this appliance and shall be installed for the protection of children and other at-risk individuals. If the barrier becomes damaged, the barrier shall be replaced with the manufacturer's barrier for this appliance.

Clothing or other flammable material should not be placed on or near the appliance.

Any screen or guard removed for servicing an appliance must be replaced prior to operating the appliance.

Fireplace

Keep Furniture
and Other Objects
36" from Fireplace

36" (91.44cm)

Installation and repair should be done by a licensed service technician. The appliance should be inspected before use and at least annually by a professional service technician. More frequent cleaning may be required due to excessive lint from carpeting, bedding material, etc. It is imperative that the control compartments, burners and circulating air passageways of the appliance be kept clean. Warranty void if not.

WARNING: Do not operate the appliance with the glass door assembly removed, or if the glass is cracked or broken. Replacement of the glass should be done by a qualified service technician.

WARNING: Use only glass assembly, P/N 48-510 for FORTY8, P/N 60-510 for SIXTY0, P/N 72-510 for SEVENTY2, which includes the glass panel, frame and gasket. Do not use substitute materials. Do not strike or slam the glass front. Do not use abrasive cleaners. Do not clean when hot.

CAUTION: Do not operate with broken glass.

MODEL DESCRIPTIONS

FORTY8 Models

FORTY8 SEE-THRU
MODEL NO. BI-48-ST

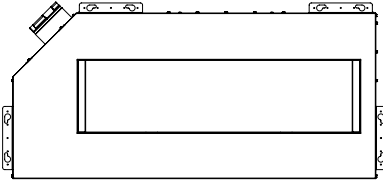

(See-Thru Model can be installed
with Left or Right Vent)

FORTY8 SINGLE SIDE
(Left side vent exit)
MODEL NO. BI-48-SSL

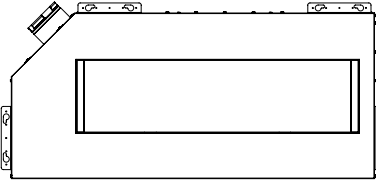

FORTY8 SINGLE SIDE
(Right side vent exit)
MODEL NO. BI-48-SSR

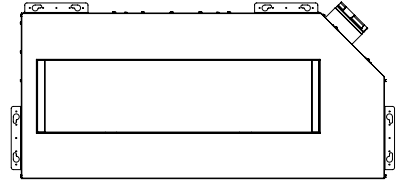

SIXTY0 Models

SIXTY0 SEE-THRU
MODEL NO. BI-60-ST

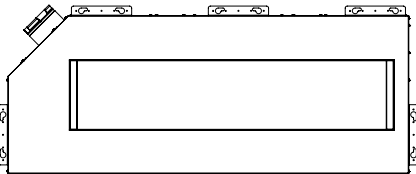

(See-Thru Model can be installed
with Left or Right Vent)

SIXTY0 SINGLE SIDE
(Left side vent exit)
MODEL NO. BI-60-SSL

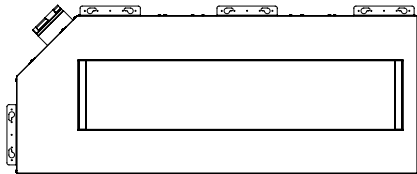

SIXTY0 SINGLE SIDE
(Right side vent exit)
MODEL NO. BI-60-SSR

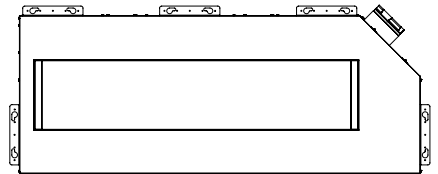

SEVENTY2 Models

SEVENTY2 SEE-THRU
MODEL NO. BI-72-ST

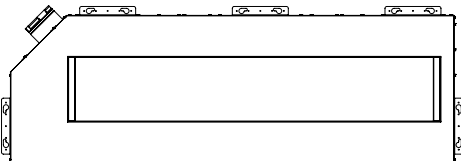

(See-Thru Model can be installed
with Left or Right Vent)

SEVENTY2 SINGLE SIDE
(Left side vent exit)
MODEL NO. BI-72-SSL

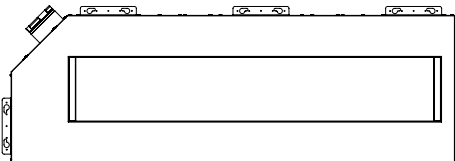

SEVENTY2 SINGLE SIDE
(Right side vent exit)
MODEL NO. BI-72-SSR

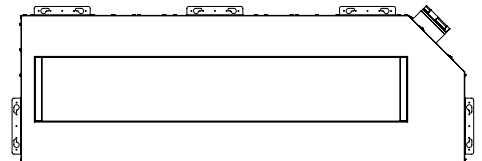

CERTIFICATION

This appliance has been certified by PFS TECO to ANSI Z21.88-2014/CSA 2.33-2014 Vented Gas Fireplace Heaters and CAN/CGA 2.17-M91 (2014), Gas-Fired Appliances for Use At High Altitudes.

This SÓLAS Gas Fireplace is approved for installation at elevations up to 2000 feet in the U.S. and 1370 meters (4500 feet) in Canada without change. If your installation is at an

elevation greater than those noted, consult with the local authority having jurisdiction for gas product installations to determine their specific requirements for high altitude installations.

These appliances are approved for installation in the Commonwealth of Massachusetts by the Board of State Examiners of Plumbers and Gas Fitters.

SÓLAS DIRECT VENT GAS FIREPLACES

VENTED GAS FIREPLACE HEATER
NOT FOR USE WITH SOLID FUEL

SERIAL NUMBER: BI-20-

BI-48-ST BI-48-SSL BI-48-SSR

EQUIPPED FOR -	<input type="checkbox"/> Natural Gas/Gaz Naturel	<input type="checkbox"/> Propane	- ÉQUIPÉ POUR
Input Rating	26,000 BTU/hr	30,000 BTU/hr	Debit Calorifique
Min. Input Rating	16,000 BTU/hr	19,000 BTU/hr	Puissance Minimum
Orifice - DMS	#42	#52	L'injecteur
Manifold Pressure	3.5" w.c. / 0.9kPa	10.0" w.c. / 2.5kPa	Press. A la tubulure
Min. Supply Pressure	5.5" w.c. / 1.4kPa	11.0" w.c. / 2.8kPa	Press. D'Arrivée Min.
Max Supply Pressure	10.0" w.c. / 2.5kPa	13.0" w.c. / 3.3kPa	Press. D'Arrivée Max.

For use only with barrier(s) Part No. 11223. Follow installation instructions.

A utiliser uniquement avec des barrière(s) Référence 11223. Suivez les instructions d'installation

BI-60-ST BI-60-SSL BI-60-SSR

EQUIPPED FOR -	<input type="checkbox"/> Natural Gas/Gaz Naturel	<input type="checkbox"/> Propane	- ÉQUIPÉ POUR
Input Rating	30,000 BTU/hr	34,000 BTU/hr	Debit Calorifique
Min. Input Rating	21,000 BTU/hr	15,000 BTU/hr	Puissance Minimum
Orifice - DMS	#49	#56	L'injecteur
Manifold Pressure	3.5" w.c. / 0.9kPa	10.0" w.c. / 2.5kPa	Press. A la tubulure
Min. Supply Pressure	5.5" w.c. / 1.4kPa	11.0" w.c. / 2.8kPa	Press. D'Arrivée Min.
Max Supply Pressure	10.0" w.c. / 2.5kPa	13.0" w.c. / 3.3kPa	Press. D'Arrivée Max.

For use only with barrier(s) Part No. 11218. Follow installation instructions.

A utiliser uniquement avec des barrière(s) Référence 11218. Suivez les instructions d'installation

BI-72-ST BI-72-SSL BI-72-SSR

EQUIPPED FOR -	<input type="checkbox"/> Natural Gas/Gaz Naturel	<input type="checkbox"/> Propane	- ÉQUIPÉ POUR
Input Rating	34,000 BTU/hr	40,000 BTU/hr	Debit Calorifique
Min. Input Rating	27,000 BTU/hr	28,000 BTU/hr	Puissance Minimum
Orifice - DMS	#46	#55	L'injecteur
Manifold Pressure	3.5" w.c. / 0.9kPa	10.0" w.c. / 2.5kPa	Press. A la tubulure
Min. Supply Pressure	5.5" w.c. / 1.4kPa	11.0" w.c. / 2.8kPa	Press. D'Arrivée Min.
Max Supply Pressure	10.0" w.c. / 2.5kPa	13.0" w.c. / 3.3kPa	Press. D'Arrivée Max.

For use only with barrier(s) Part No. 11226. Follow installation instructions.

A utiliser uniquement avec des barrière(s) Référence 11226. Suivez les instructions d'installation

MINIMUM CLEARANCES TO COMBUSTIBLE CONSTRUCTION DISTANCES MINIMALES PAR RAPPORT AUX MATERIAUX INFLAMMABLES

FIREPLACE SIDES	4" (102mm)	FOYER CÔTÉS
FIREPLACE TOP	4" (102mm)	FOYER TOP
FIREPLACE FLOOR*	1/2" (13mm)	FOYER DE CHAUSSE*
FIREPLACE BACK (SINGLE SIDED)	2" (51mm)	FOYER RETOUR (UNIQUE CÔTÉ)
FIREPLACE BACK (SEE-THRU)	12" (305mm)	FOYER RETOUR (VOIR-PAR)
FIREPLACE FRONT	12" (305mm)	FOYER AVANT
CLEARANCE AROUND VENT PIPE	1.5" (38mm)	JEU AUTOUR VENT PIPE

*1/2" non-combustible under fireplace floor must have R factor of no less than 1.0

*13mm non-combustible sous cheminée plancher doit avoir facteur R de pas moins de 1.0

This product has been certified by PFS-TECO to ANSI Z21.88-2014 - CSA 2.33-2014 Vented Gas Fireplace Heaters, and CAN/CGA 2.17-M91 (2014), Gas-Fired Appliance For Use At High Altitudes. This appliance is equipped only for altitudes from 0-2000 feet (0-610m). In Canada 0-4500 feet (0-1370m). This appliance must be installed in accordance with local codes, if any; if none, follow the National Fuel Gas Code, ANSI Z223.1/NFPA 54, or Natural Gas and Propane Installation Codes, CSA-B149.1.

This appliance is for use only with the type of gas indicated on the rating plate. This appliance may be installed in an aftermarket, permanently located manufactured home (USA only) or in a mobile home, where not prohibited by local codes. See Owner's Manual for details.

This appliance is not field convertible for use with other gases, unless a certified conversion kit is used.

This appliance may be recessed 12.5 inches within combustible construction.

This appliance may be installed with a combustible mantle of no more than 12 inches deep at a minimum of 14.25 inches above the fireplace opening.

NOT FOR USE WITH GLASS DOORS.

HRD-750 - Heat Redistribution Blower Kit may be used with this appliance.



Manufactured by:
Progressive Manufacturing Inc.
452 Sunapee Street
Newport, NH 03773
U.S.A.

SÓLAS DIRECT VENT GAS FIREPLACES

CAUTION: HOT WHILE IN OPERATION. DO NOT TOUCH, SEVERE BURNS MAY RESULT. KEEP CHILDREN, CLOTHING, FURNITURE, GASOLINE, AND OTHER LIQUIDS HAVING FLAMMABLE VAPORS AWAY.

CAUTION: Do not operate the appliance with the glass removed, cracked, or broken. Replacement of the glass panel(s) should be done by a licensed or qualified service person. See the Owner's Manual.

CAUTION: Label all wires prior to disconnection when servicing. Wiring errors can cause improper and dangerous operation. Verify Proper operation after servicing.

Electrical rating - Total input of all components is less than 2.5 amperes.

WARNING: Improper installation, adjustment, alteration, service, or maintenance can cause injury or property damage. Refer to the owner's information manual provided with this appliance. For assistance or additional information, consult a qualified installer, service agency, or the gas supplier.

This appliance must be properly connected to a venting system in accordance with the manufacturer's installation instructions.

Keep burner and control compartments clean. See installation and operating instructions accompanying appliance.

This vented fireplace is not for use with air filters.

Ce produit a été testé et répertorié PFS TECO conformément au ANSI Z21.88-2014 - CSA 2.33-2014, CAN/CGA 2.17-M91 (2014), et CSA P.4.1-09. Cet appareil peut être utilisé à des altitudes comprises entre 0 et 610m (0 et 2000 pieds) (E.U. seulement) ou entre 0 et 1370m (0 et 4500 pieds) (Canada seulement) sans modification. Installez l'appareil selon les codes ou règlements, ou dans l'absence de tels règlements, selon les codes d'installation, ANSI Z223.1 National Fuel Gas Code, ou CSA-B149.1 en vigueur. Cet appareil doit être correctement raccordé à un système d'évacuation conformément aux instructions du fabricant.

Cet appareil peut être installé dans une maison préfabriquée (É.-U. seulement) ou mobile déjà installée à demeure si les règlements locaux le permettent. Voir la notice de l'utilisateur pour plus de renseignements. Cet appareil doit être utilisé uniquement avec les types de gaz indiqués sur la plaque signalétique. Cet appareil ne peut pas être utilisé avec d'autres gaz sauf si une trousse de conversion certifiée est fournie.

Cet appareil peut être encastré 318mm au sein de construction combustible

Cet appareil peut être installé avec un manteau combustible de pas plus de 305mm de profondeur à un minimum de 362 au-dessus de l'ouverture du foyer.

NE PAS UTILISER AVEC PORTES EN VERRE

HRD-750 - Heat Redistribution Blower Kit peut être utilisé avec cet appareil.

ATTENTION: L'appareil est chaud lorsqu'il fonctionne. Ne pas toucher l'appareil. Risque de brûlures graves surveiller les enfants. Garder les vêtements, les meubles, l'essence ou autres liquides produisant des vapeurs inflammables loin de l'appareil.

AVERTISSEMENT: Une installation, un réglage, une modification, une réparation ou un entretien mal effectué peut causer des dommages matériels ou des blessures. Voir la notice de l'utilisateur qui accompagne l'appareil. Pour de l'aide ou des renseignements supplémentaires, consultez un installateur, un technicien agréé ou le fournisseur de gaz.

ATTENTION: Avant de le faire des réparations, marquez tous les fils avant de les débrancher. Les erreurs avec le circuit électronique peuvent causer des fonctionnements dangereux et incorrects.

ATTENTION: Ne pas utiliser l'appareil si le panneau frontal en verre n'est pas en place, est craqué ou brisé. Confiez le remplacement de panneau à un technicien agréé.

S'assurer que le brûleur et le compartiment des commandes sont propres. Voir les instructions d'installation et d'utilisation qui accompagnent l'appareil.

Ne pas utiliser de filtre à air avec ce foyer au gaz évacuation.



FABRIQUÉ PAR:
Progressive Manufacturing Inc.
452 Sunapee Street
Newport, NH 03773
U.S.A.

*Rating Label (affixed to Control Panel within Firebox)

SPECIFICATIONS

NATURAL GAS SPECIFICATION CHART

INPUT	FORTY8	SIXTY0	SEVENTY2
Input Rating BTU/Hr.	26,000	30,000	34,000
Min. Input BTU/Hr.	16,000	21,000	27,000
Orifice Size - DMS	#42	#49	#46
GAS SUPPLY	FORTY8	SIXTY0	SEVENTY2
Manifold Pressure	3.5" w.c. / 0.9kPa	3.5" w.c. / 0.9kPa	3.5" w.c. / 0.9kPa
Min. Supply Pressure	5.5" w.c. / 1.4kPa	5.5" w.c. / 1.4kPa	5.5" w.c. / 1.4kPa
Max. Supply Pressure	10.0" w.c. / 2.5kPa	10.0" w.c. / 2.5kPa	10.0" w.c. / 2.5kPa

PROPANE (LP) SPECIFICATION CHART

INPUT	FORTY8	SIXTY0	SEVENTY2
Input Rating BTU/Hr.	30,000	34,000	40,000
Min. Input BTU/Hr.	19,000	25,000	28,000
Orifice Size - DMS	#52	#56	#55
GAS SUPPLY	FORTY8	SIXTY0	SEVENTY2
Manifold Pressure	10.0" w.c. / 2.5kPa	10.0" w.c. / 2.5kPa	10.0" w.c. / 2.5kPa
Min. Supply Pressure	11.0" w.c. / 2.8kPa	11.0" w.c. / 2.8kPa	11.0" w.c. / 2.8kPa
Max. Supply Pressure	13.0" w.c. / 3.3kPa	13.0" w.c. / 3.3kPa	13.0" w.c. / 3.3kPa

EFFICIENCY NG / LP	FORTY8	SIXTY0	SEVENTY2
*Typical Installation, Steady State Efficiency - %	62.2/68.4	69/73.9	72.6/76.4
Steady State Efficiency - %	61/63.4	64.8/70.8	70.4/74.8
Annual Fuel Utilization Efficiency (AFUE) - %	59/61.4	62.8/68.6	68.2/72.5
Canadian p.4 Efficiency - %	65.7/62	64.5/67.7	69.8/72.7
Max. Supply Pressure	13.0" w.c. / 3.3kPa	13.0" w.c. / 3.3kPa	13.0" w.c. / 3.3kPa

**Your efficiency will increase with the length of the vent run.
The typical installation tested is 5 ft vertical and 5 ft horizontal.*

NOTE: The maximum achievable steady state efficiency can vary depending on how the fireplace is installed and operated.

- It is recommended that the pilot flame be turned off if the appliance will not be in use for an extended period of time.
- This appliance is equipped for use with the fuel type indicated on the rating plate. Field conversion is only permitted by with a conversion kit supplied by SÓLAS and installed by a licensed service technician.

SPECIFICATIONS

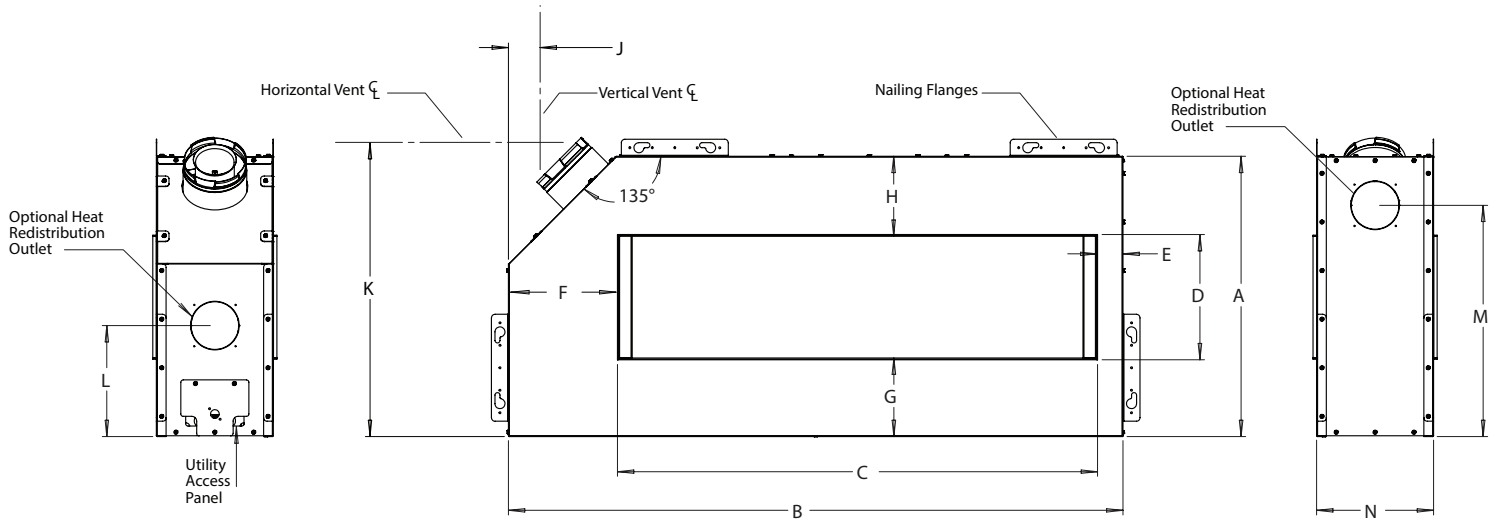

Dimension	FORTY8	SIXTY0	SEVENTY2
Dimension A	29" (737mm)	29" (737mm)	29" (737mm)
Dimension B	63 5/8" (1616mm)	73 5/8" (1870mm)	87 5/8" (2226mm)
Dimension C	49 1/4" (1251mm)	59 1/4" (1505mm)	73 1/4" (1861mm)
Dimension D	12 3/4" (324mm)	12 3/4" (324mm)	12 3/4" (324mm)
Dimension E	2 23/32" (69mm)	2 23/32" (69mm)	2 23/32" (69mm)
Dimension F	11 5/16" (287mm)	11 5/16" (287mm)	11 5/16" (287mm)
Dimension G	7 61/64" (202mm)	7 61/64" (202mm)	7 61/64" (202mm)
Dimension H	8 1/8" (206mm)	8 1/8" (206mm)	8 1/8" (206mm)
*Dimension J	3 1/4" (83mm)	3 1/4" (83mm)	3 1/4" (83mm)
*Dimension K	30 1/4" (768.5mm)	30 1/4" (768.5mm)	30 1/4" (768.5mm)
Dimension L	11 1/2" (292mm)	11 1/2" (292mm)	11 1/2" (292mm)
Dimension M	23 7/8" (606.5mm)	23 7/8" (606.5mm)	23 7/8" (606.5mm)
Dimension N	12" (305mm)	12" (305mm)	12" (305mm)

*The Horizontal and Vertical vent centerline dimensions account for the use of a 45° elbow.

The gas fireplace is shipped with a 3/8" tube OD (female) gas connection. The gas supply piping should have a separate gas shutoff valve and a 1/8" NPT plugged tapping upstream of the valve. The fireplace and its main control valve must be disconnected from the gas supply piping system during any pressure testing of that system at test pressures in excess of 1/2 psi (3.5 kPa). The fireplace must be isolated from the gas supply piping system by closing the main control valve during any pressure testing of the gas supply system at test pressures equal to or greater than 1/2 psi (3.5 kPa). After the gas supply has been connected, use a commercial gas leak detector or apply a soapy water solution to all the fittings to check for gas leaks. Never use a flame to test for leaks.

CLEARANCES

MINIMUM CLEARANCES TO COMBUSTIBLE CONSTRUCTION

Dimension Description	FORTY8	SIXTY0	SEVENTY2
Top & Sides	4" (102mm)	4" (102mm)	4" (102mm)
Floor	1/2" (13mm)	1/2" (13mm)	1/2" (13mm)
Back (Single Sided)	2" (51mm)	2" (51mm)	2" (51mm)
Back (See-Thru)	12" (305mm)	12" (305mm)	12" (305mm)
Front	12" (305mm)	12" (305mm)	12" (305mm)
Clearance around vent pipe	1.5" (38mm)	1.5" (38mm)	1.5" (38mm)

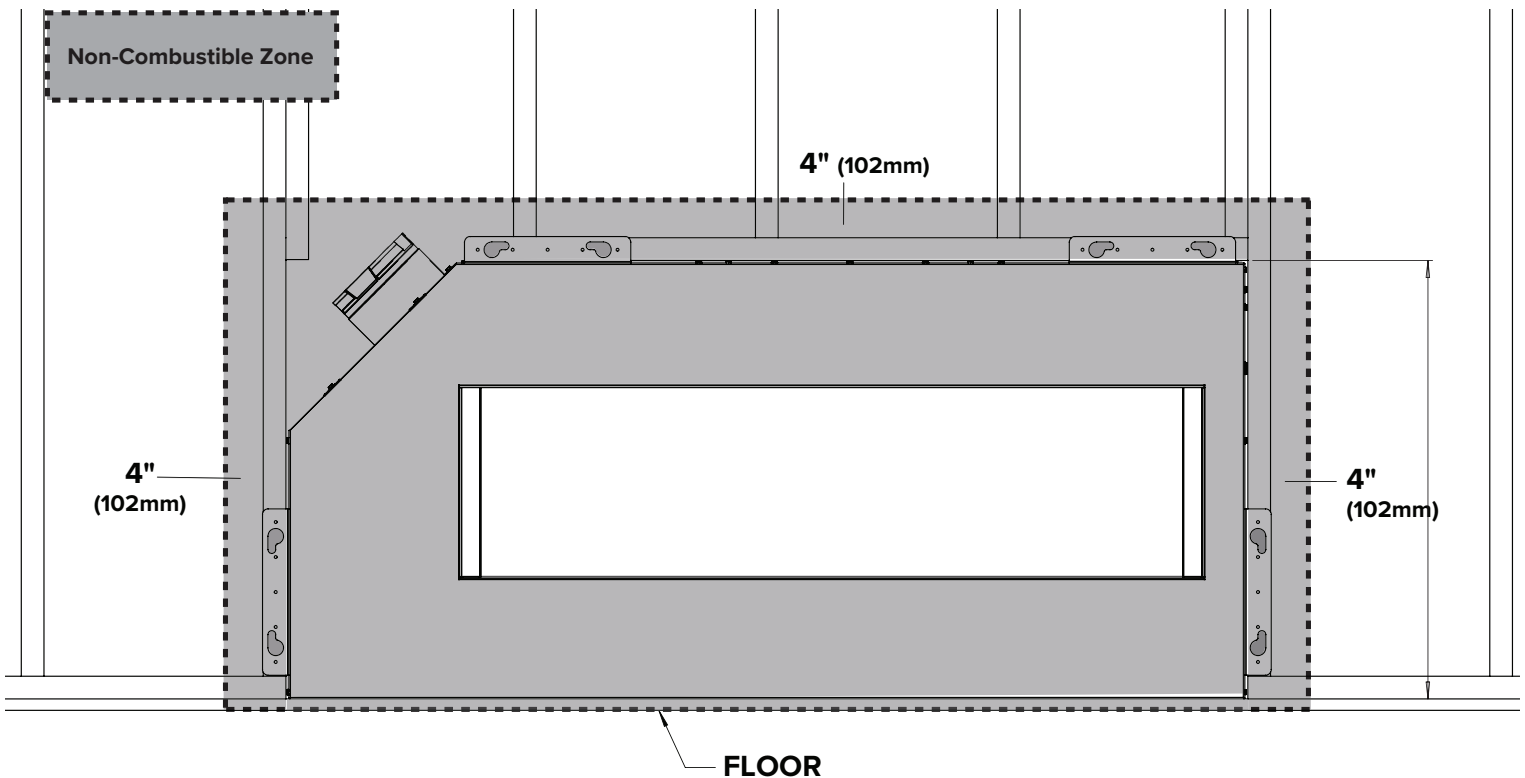

The above image shows an example of how to frame the wall before the fireplace is moved into position.

- All framing, finishing, and construction materials that fall within 4" (102mm) of either the sides or top of the fireplace must be non-combustible. (Shown with a dashed line in the image above) The sheet metal face of this fireplace must be covered by a non-combustible material, it may not be left exposed.
- Any materials that cover the front face or rear face of the fireplace must be non-combustible. Allow clearance for removal of fireplace trim, screen, and glass.
- The fireplace must be secured to the framing studs using the nailing flanges as shown above. Use 2 screws or nails per nailing flange to secure the fireplace.

- The floor the fireplace immediately rests on must be constructed of non-combustible material with a K value of at least 1.0, (R value of at least 0.39), with a minimum thickness of 1/2" (13mm).
- Note that the vent starter collar sits slightly above the top surface of the fireplace can, there must be clearance to allow the fireplace with starter collar to slide into place.
- This framing guide is just an example of the many ways in which a SÓLAS Fireplace can be installed. You may need to customize this framing design to allow for things such as doors, windows, countertops, structural frame members, or local code requirements.

Optional SÓLAS Cool Zone Kit available for reduced clearances. Learn more @ solasfires.com

CLEARANCES

SLIM-LINE BUILT-IN VIEWING AREA CENTERING DIMENSIONS

With the unique installation and venting versatility of the SÓLAS Slim-Line Built-In Fireplace, there is an offset flue location that makes the viewing area not centered on the fireplace. The guide below will help you center the fireplace viewing area on the wall, if desired. **Note: Single-sided models can be ordered with Left or Right side venting.**

Dimension	Dimension Description	FORTY8	SIXTY0	SEVENTY2
AA	Viewing Area	49.25" (1,251mm)	59.25" (1,505mm)	73.25" (1,861mm)
BB	Non-flue side spacing	2.70" (69mm)	2.70" (69mm)	2.70" (69mm)
CC	Flue side spacing	11.30" (287mm)	11.30" (287mm)	11.30" (287mm)
DD	Non-combustible requirement, side	4.00" (102mm)	4.00" (102mm)	4.00" (102mm)
EE	Distance required to center viewing area	35.93" (913mm)	40.93" (1,040mm)	47.93" (1,217mm)
FF	Distance required to center viewing area, including non-combustible requirement	39.93" (1,014mm)	44.93" (1,141mm)	51.93" (1,319mm)
GG	Minimum wall space required to center viewing area	71.85" (1,825mm)	81.85" (2,079mm)	95.85" (2,435mm)
HH	Minimum wall space required to center viewing area including non-combustible requirement	79.85" (2,028mm)	89.85" (2,282mm)	103.85" (2,638mm)

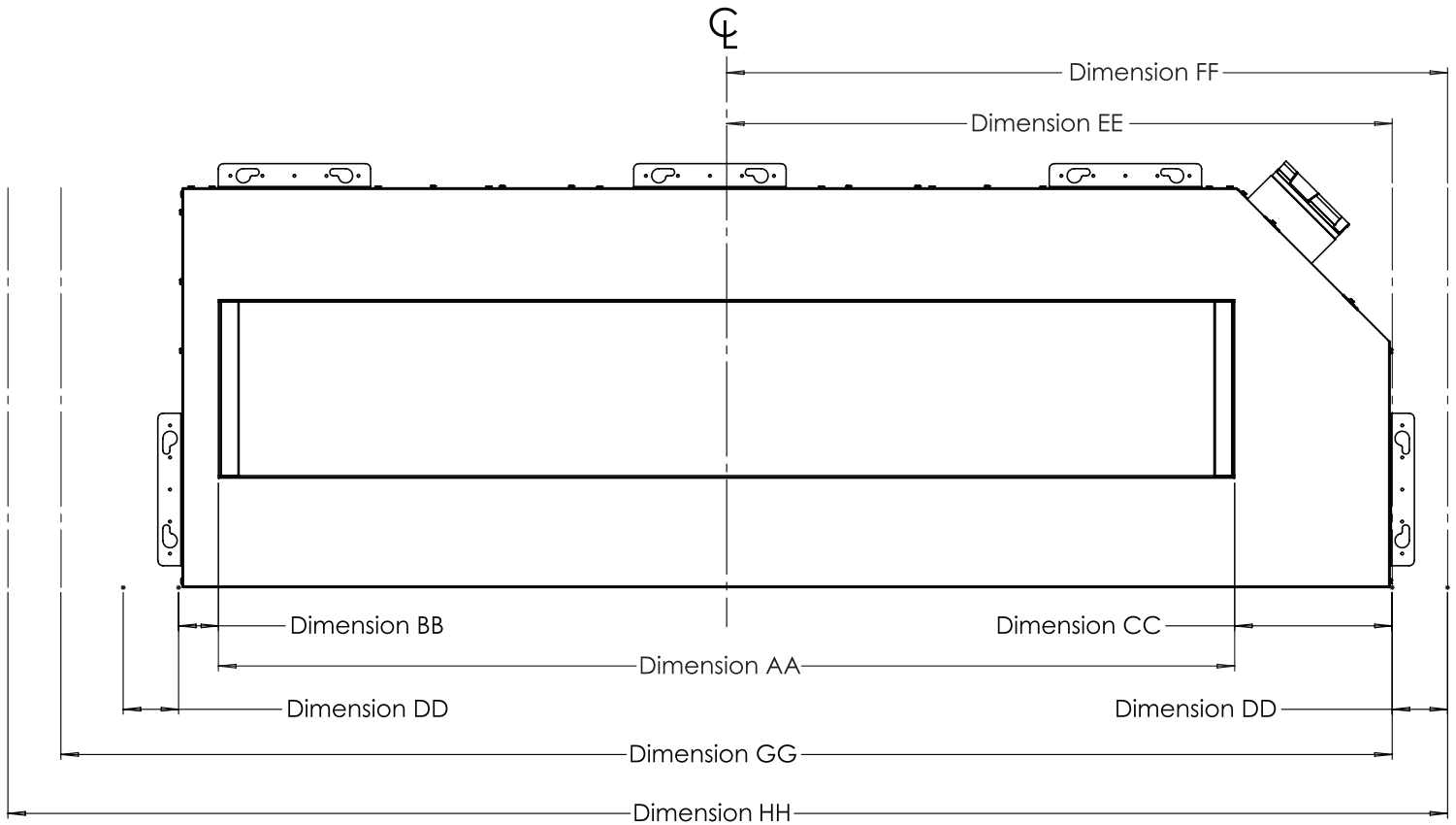

CLEARANCES

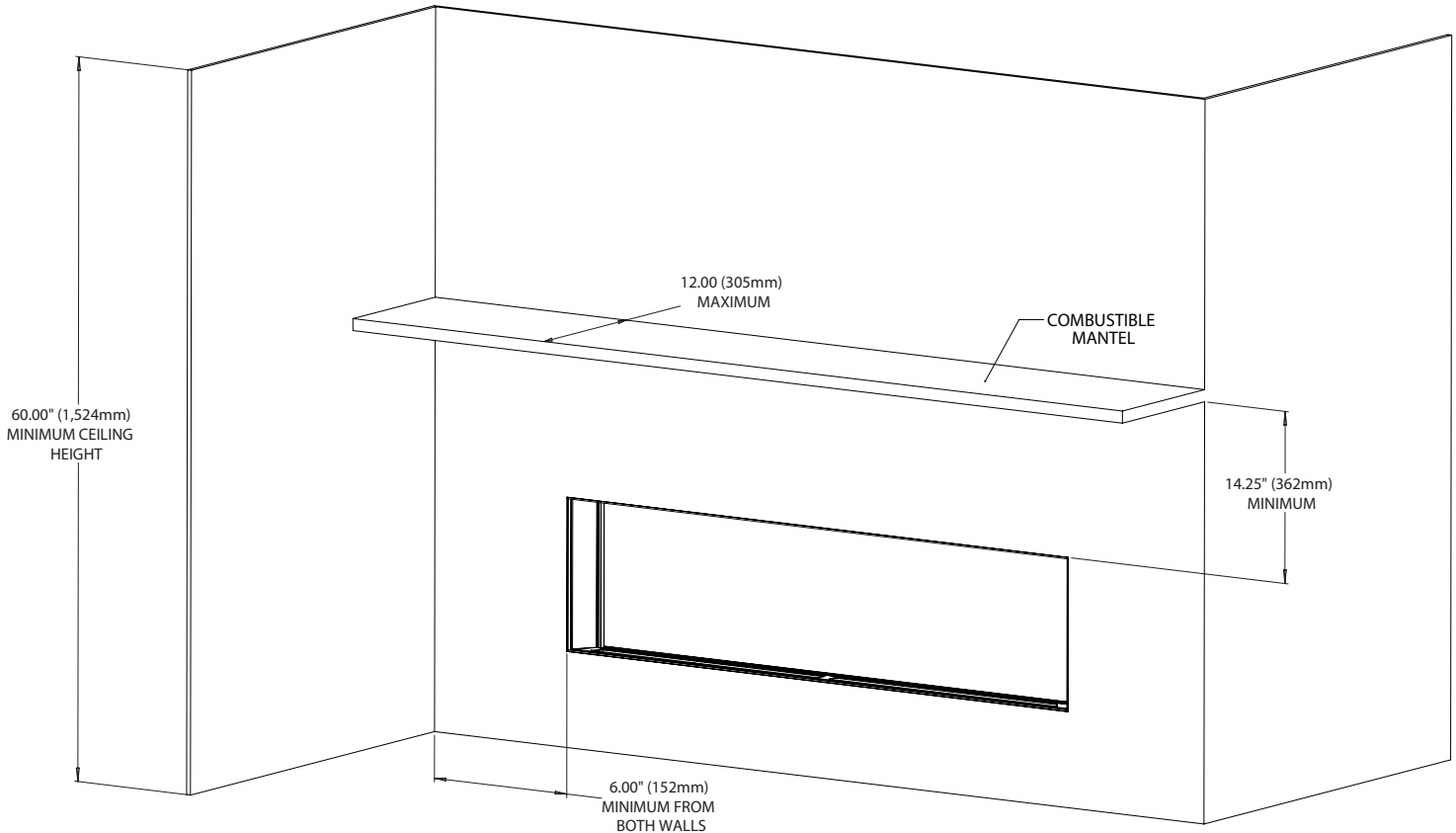

WARNING

Follow these instructions carefully to ensure safe installation.

Failure to follow instructions exactly can create a fire hazard.

- Combustible Mantels must be no less than 14.25" (362mm) above the viewing area of the fireplace (as shown above). Any combustible finishing materials used between the top of the non-combustible zone (12.125" (308mm) above the viewing area) and the minimum mantel height can protrude no more than 3/4" (19mm), if it does, it is considered a mantel and is subject to the 14.25" (362mm) minimum distance above the viewing area.
- When selecting non-combustible materials for use in the installation, take note of the material's propensity to absorb and conduct heat. Materials such as metal, stone, and ceramics may transmit heat more readily than other building materials.
- Only non-combustible materials (i.e. brick, tile, slate, steel, or other man made materials with a UL fire rating of Zero) may be used in the construction and installation of this fireplace. Any material must be fastened to surrounding framing. NOT to the face of the fireplace.

ATTENTION:

Before proceeding with your installation, determine if you plan to use either the Self-Calibrating Power Vent Kit, Cool Zone Kit, or the Heat Redistribution Kit. Read the manual for these optional components before proceeding with your installation, as your installation requirements and procedure may change.

Optional SÓLAS Cool Zone Kit available for reduced clearances

Learn more @ solasfires.com

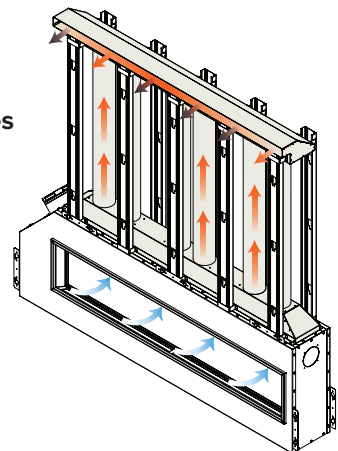

FINISHING INFORMATION & PLANNING

NOTE: SÓLAS can only offer guidance as to the type of materials that can be safely used during the installation of your fireplace and cannot comment on, or be responsible for, any finishing material's propensity for fading, flaking, discoloring, cracking, or chipping due to improper installation and/or thermal expansion. Be sure to consider a material's propensity to "off-gas" when hot as this may cause discomfort for the end user.

NOTE: For a Minimal "Clean" look, we recommend using materials that have been tested for specific high heat applications and are designed not to crack or chip such as Promat and Skamol products. Any other materials used to achieve this same look might not perform as intended and are likely to discolor, crack and/or chip.

FINISHING SUGGESTIONS:

When using any of the options below be sure to extend the non-combustible board as far beyond the non-combustible zone as is feasible to avoid cracking due to differing thermal coefficients of expansion between adjacent materials.

Standard gypsum board may be used beyond the perimeter of the non-combustible zone however it is preferable not to change materials to help avoid cracking. Ensure that all compound, mortar, and/or silicone adhesives are rated for high-temperature applications and have fully cured before using the fireplace to help reduce the possibility of cracking as a result of thermal expansion.

• Tile and Stone Veneer Products:

Install a minimum of ½" non-combustible cement board then apply tile or stone with mortar following instructions from the finishing material company. Pre-drill cement board with oversized holes and do not over-tighten screws to avoid cracking due to thermal expansion.

• Natural Stone, Marble or Granite Type Products:

Install a minimum of ½" non-combustible cement board then apply tile or stone with mortar following instructions from the finishing material company. Pre-drill cement board with oversized holes and do not over-tighten screws to avoid cracking due to thermal expansion.

ATTENTION: Follow non-combustible clearance zone requirements when installing finishing materials.

All materials including adhesives and compounds used within areas marked as non-combustible zones are required to be rated for minimum of 500°F. It is normal for the exposed surfaces around the fireplace viewing area to be hot to touch. Refer to material data sheets, do not use finishing materials with additives such as but not limited to polymers, epoxy or resins.

ATTENTION: Research all materials used in the installation of your fireplace to insure they meet the non-combustible requirements and are suitable for high temperature environments, marketing terms such as "Fire Rated", "Fire Proof" or "Fire Resistant" do not necessarily mean a material is classified as non-combustible and is suitable for high temperature environments.

Additional tips to help avoid cracking;

- Allow materials to dry thoroughly before finishing the wall.
- Always pre-drill cement board with oversized holes and use screws with self-milling head.
- Always use tape over joints.
- Double up studs or use studs "on the flat" to add extra support to the joint. Help control differential movement by applying adhesive on the backside of the wall board joints.
- Use multiple, thinner coats of joint compound and allow to completely dry between coats.
- Ensure all framing materials are dry.
- Introduce heat gradually after finishing the wall to slowly dry any excess moisture.
- Avoid notching tiles or cement board around corners of window opening and instead provide a joint that intersects the corner.
- Take guidance from your authorized fireplace dealer and experienced installer.

Consult installation and operating instructions supplied with your SÓLAS fireplace for complete instructions for the installation and operation of the appliance.

NOTE: Prior to enclosing the wall cavity, test fire the fireplace to ensure it is fully operational.

INSTALLATION INFORMATION

ELECTRICAL AND PLUMBING

The electrical and plumbing access panel is located on the vent side of the unit.

1. Remove the (3) #10 sheet metal screws using a $\frac{5}{16}$ " nut driver that hold the utility access panel to the fireplace.
2. Remove the utility access panel from the fireplace exposing the junction box and gas line.
3. Remove 3 prong plug(s) from the junction box outlets attached to the utility access panel.
4. Have a licensed electrician hardwire the junction box provided in accordance with local codes. The electrical supply required is 120v, 2.5 amps.
 - It is recommended this fireplace be installed on its own electrical circuit.
 - Strain reliefs are required on electrical connections entering the junction box.
5. Reinstall 3 prong plug(s) in junction box outlets.
6. Have a licensed plumber connect gas piping to the $\frac{3}{8}$ " female flare connection provided in accordance with local codes. Be sure to check for gas leaks.
7. Reinstall utility access panel with the (3) #10 sheet metal screws using a $\frac{5}{16}$ " nut driver.

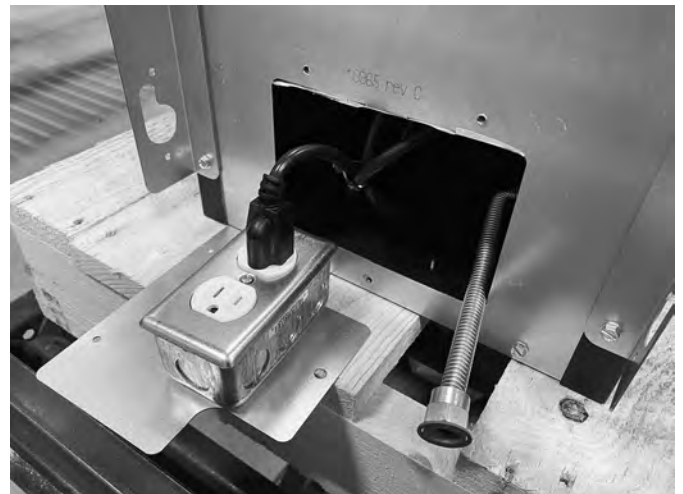
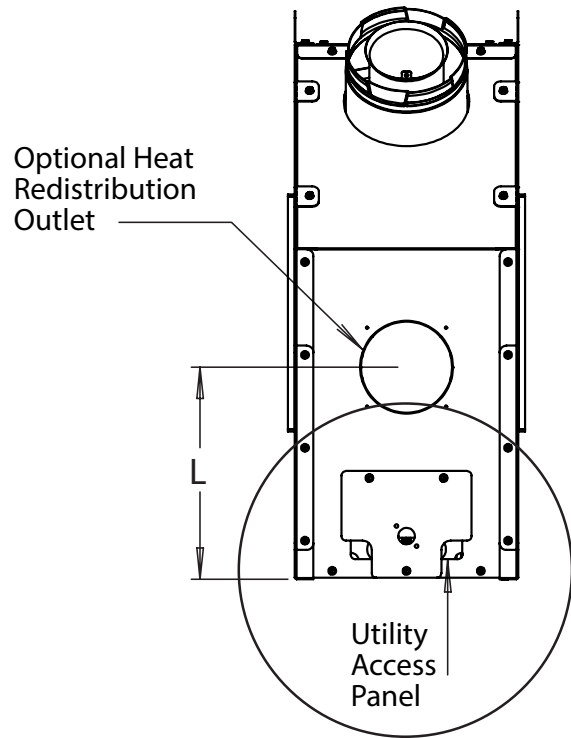

INSTALLATION INFORMATION

COMFORT BLOWER

Your SÓLAS fireplace is equipped with a Comfort Blower to help efficiently move heat into your living space.

The Comfort Blower has 4 speed levels controlled by the SÓLAS One-Touch remote. See bottom right column of page 36 for details on remote operation.

In the event of a power outage, your fireplace will continue to operate, but the Comfort Blower will not function. Once power is restored you can use the Comfort Blower.

We recommend using your Comfort Blower on speed 1 or 2 which will help move a sufficient amount of warm air from your fireplace into your heating zone while remaining quiet. With the increased air speed of levels 3 and 4, there will be a noticeable difference in sound.

We recommend during the annual service on your fireplace Comfort Blower, use a vacuum and/or compressed air to remove any dust, pet hair etc. When servicing your fireplace, first shut off power to it.

The Comfort Blower is located to the left of the gas valve located under the air screen assembly (as shown in image below). To gain access to the Comfort Blower please see page 26 first for Screen Removal.

In the event your Comfort Blower needs replacing, a licensed service technician can remove the Comfort Blower by removing the (2) $\frac{1}{4}$ -20 nuts with a $\frac{7}{16}$ " driver, located on each side of the Comfort Blower as shown in the image below.



INSTALLATION INFORMATION

WARNING

Read all instructions completely and thoroughly before attempting installation. Failure to do so could result in serious injury, property damage, or loss of life. Operation of improperly installed or maintained venting system could result in serious injury, property damage, or loss of life.

NOTE:

Any electrical wiring, gas plumbing, or vent installation required by the appliance must be done prior to final finishing. The unit shall be test burned on high for at least 30 minutes prior to final finishing to confirm proper operation. Failure to test the appliance before final finishing may require significant and costly reconstruction.

INSTALLATION PRECAUTIONS

Consult local building codes before beginning the installation. The installer must make sure to select the proper vent system for installation. Before installing the vent kit, the installer must read this fireplace manual and vent kit instructions. Only a qualified, licensed, installer/service technician shall install the venting system. The installer must follow the following safety rules:

- Wear gloves and safety glasses for protection.
- Use extreme caution when using ladders or when on rooftops.
- Be aware of electrical wiring locations in walls and ceilings.

The following actions will void the warranty on your fireplace:

- Installation and service by non-qualified or unlicensed technician.
- Installation of any damaged venting component.
- Unauthorized modification of the appliance.
- Unauthorized modification of the venting system.
- Installation of any component part not manufactured or approved by SÓLAS Contemporary Fires.
- Installation other than permitted by these instructions.

NOTICE

Failure to follow these instructions will void the warranty.

WARNING: Unauthorized modifications of this appliance may result in property damage, injury or loss of life.

INSTALLATION INFORMATION

STATE OF MASSACHUSETTS

The installation must be completed by a licensed plumber or gas fitter in the Commonwealth of Massachusetts.

REQUIREMENTS FOR THE COMMONWEALTH OF MASSACHUSETTS

This product must be installed by a licensed plumber or gas fitter when installed within the Commonwealth of Massachusetts. If this appliance is installed in a dwelling, building or structure used in whole or in part for residential purposes and the installation includes a horizontal vent termination that is less than seven (7) feet above the finished grade in the area of the venting, including but not limited to decks and porches, a hard-wired carbon monoxide detector with an alarm and battery back-up must be installed on the floor level of the dwelling, building or structure where the appliance is to be installed.

Additionally, a hard-wired or battery operated carbon monoxide detector with an alarm must be installed on each additional level of the dwelling, building or structure served by the appliance. It shall be the responsibility of the property owner to secure the services of qualified licensed professionals for the installation of hard-wired carbon monoxide detectors.

In the event that the horizontally vented appliance is installed in a crawl space or attic, the hardwired carbon monoxide detector with alarm and battery back-up may be installed on the next adjacent floor level.

In the event that this requirement cannot be met at the time of completion of the installation of the appliance, the owner shall have a period of thirty (30) days to comply with the requirement. However, during said thirty (30) day period, a battery operated carbon monoxide detector with alarm must be installed.

Each carbon monoxide detector as required in accordance with the above provisions must comply with NFPA 720 and be ANSI/UL 2034 and IAS certified.

In addition, when the vent termination is less than seven (7) feet above finished grade a metal or plastic identification plate must be permanently mounted to the exterior of the building at a minimum height of eight (8) feet above grade directly in line with the exhaust vent terminal. The sign shall read, in print size no less than one-half (½) inch in size, "GAS VENT DIRECTLY BELOW. KEEP CLEAR OF ALL OBSTRUCTIONS".

A COPY OF THESE INSTRUCTIONS PLUS ALL VENTING INSTRUCTIONS WHICH INCLUDE PARTS LISTS, AND/OR ALL VENTING DESIGN INSTRUCTIONS MUST REMAIN WITH THE STOVE AT THE COMPLETION OF THE INSTALLATION.

ATTENTION INSTALLERS: Mark below which venting system was used in the installation. These instructions must remain with the SÓLAS Gas Fireplace Installation & Operation Manual.

- Simpson DuraVent GS/PRO®
- Selkirk Direct-Temp®
- Security Secure Vent™
- AmeriVent Direct™
- Metal Fab Direct Vent
- ICC Direct Vent
- Olympia Ventis®

NOTICE

Failure to follow these instructions will void the warranty.

SÓLAS Self-Calibrating Power Vent Option Available for all SÓLAS Slim-Line Built-In Models

Learn more @ solasfires.com



VENTING

WARNING

This fireplace must be vented to the outside. The venting system must **NEVER** be attached to a chimney serving a separate solid fuel burning appliance. Each gas appliance must use a separate vent system. Do not use common vent systems.

NOTE

You may use two 45° elbows in place of a 90° elbow. You must follow rise to run ratios when using 45° elbows. The appliance is approved for use with three 90° elbows maximum or a combination of 90° and 45° elbows up to a maximum of 270°.

VENT INSTALLATION NOTE

When the first piece of Direct Vent pipe is attached to the starter collar of the fireplace, be sure to inspect both the inside and outside joints to ensure a secure fit with no air gaps. Once it is confirmed there are no gaps, rotate the pipe clockwise to lock it in place. Follow the vent manufacturer's installation instructions during vent pipe installation.

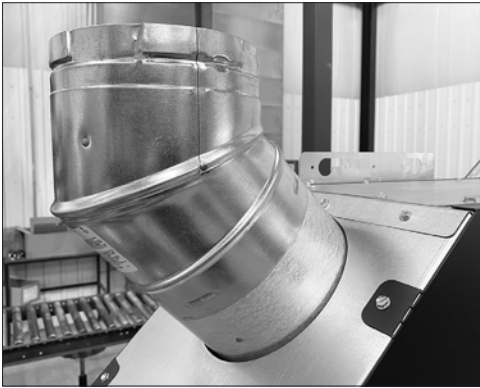

INSTALLATION PLANNING

The SÓLAS FORTY8, SIXTY0, and SEVENTY2 use 4x6 5/8" Direct-vent pipe.

There are two basic types of direct-vent installation:

- Horizontal Termination
- Vertical Termination

It is important to select the proper length of vent pipe for the type of termination you choose, taking into consideration wall thicknesses. Calculations for horizontal or vertical sections of pipe are measured between transition joints as shown in the image on the bottom of page 21. Vent runs that are not 90° vertical are considered to have horizontal run but not a vertical rise.

FOR HORIZONTAL TERMINATION

All horizontal runs of venting must have 1/4" rise for every 12" of horizontal run.

WARNING

Never run the vent pipe level or downward. This may cause excessive temperatures which could cause a fire, serious injury or loss of life, etc.

FOR VERTICAL TERMINATION

For two-story applications, firestops are required at each floor level. If an offset is needed in the attic, additional pipe and elbows will be required. It is very important that the venting system maintain its balance between the combustion air intake and the flue gas exhaust. Certain limitations apply to vent configurations and must be strictly followed.

INSTALLING A VENT SYSTEM IN AN OUTSIDE CHASE

A chase is a vertical box like structure built to enclose venting that runs along the outside of a building. A chase is required for such venting.

NOTICE

Treatment of firestops and construction of the chase may vary from building type to building type. These instructions are not substitutes for local building code requirements.

NOTICE

When installing in a chase, you should insulate the chase as you would the outside walls of your home. This is especially important in cold climates. Insulation should be considered a combustible material. Maintain proper clearances to combustibles. Also, refer to the pipe manufacturer's instructions.

VENTING

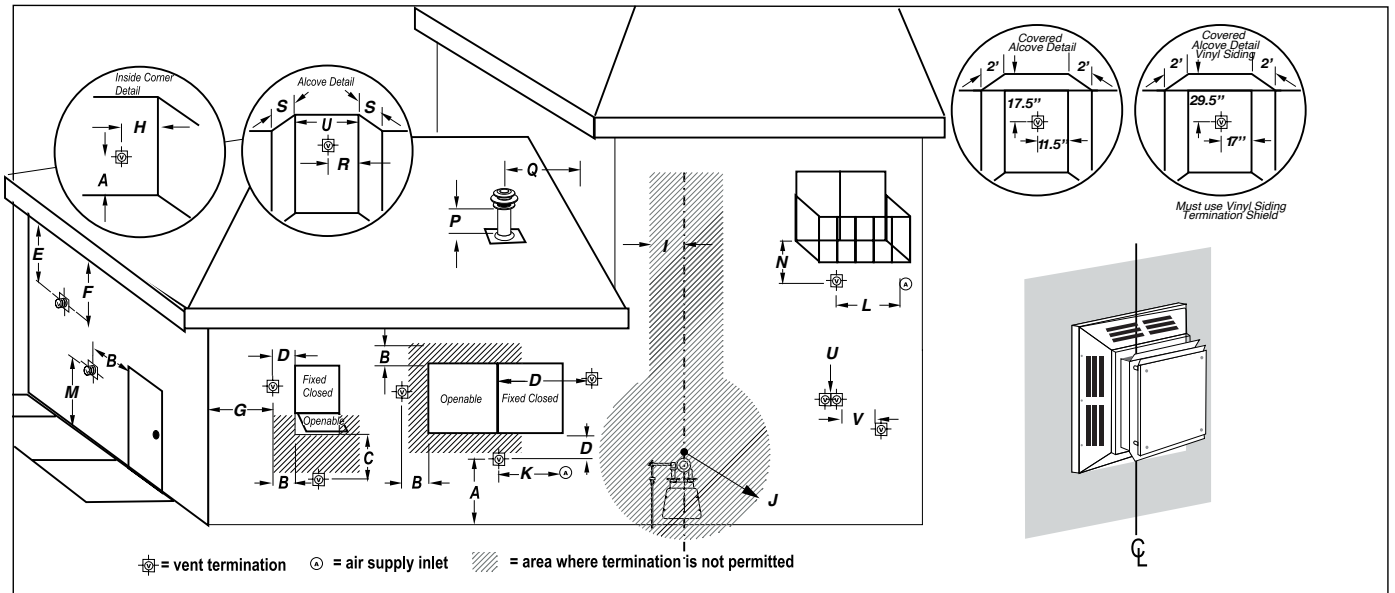

VENT TERMINAL LOCATIONS	CANADA*	U.S.A.**
A = Clearance to the termination frame above grade, veranda, porch, deck, or balcony	12" (30 cm)	12" (30 cm)
B = Clearance to top of doors or operable windows	12" (30 cm)	12" (30 cm)
C = Clearance to sides or bottom of door or operable windows	12" (30 cm)	9" (23 cm)
D = Clearance to permanently closed window, recommended to prevent condensation	16" (41 cm)	16" (41 cm)
E = Clearance to ventilated soffit located within a horizontal distance to 24" (61 cm) from centerline of termination	22" (56 cm)	22" (56 cm)
F = Clearance to unventilated soffit	30" (76 cm) to combustibles 16" (41 cm) to non-combustible	30" (76 cm) to combustibles 16" (41 cm) to non-combustible
G = Clearance to outside corner	9" (23 cm)	9" (23 cm)
H = Clearance to inside corner	12" (30 cm)	12" (30 cm)
I = Clearance to each side of the vertical centerline of a meter or regulatory assembly to a maximum vertical distance of 15ft (4.5m)	36" (91 cm)	36" (91 cm)
J = Clearance to service regulator vent outlet	36" (91 cm)	36" (91 cm)
K = Clearance to non-mechanical air supply inlet to the building or combustion air inlet to other appliance for appliance ≤100,000 BTU/H (30 kW)	12" (30 cm)	12" (30 cm)
L = Clearance to forced air supply inlet	72" (183 cm)	36" (91 cm) above air inlet
M = Clearance above paved sidewalk or paved driveway located on public property	84" (213 cm)	84" (213 cm)
N = Clearance under veranda, porch, deck, or balcony	22" to combustibles 16" to non-combustibles	22" to combustibles 16" to non-combustibles
P = Clearance above roof	24" (61 cm)	24" (61 cm)
Q = Clearance to adjacent walls and neighboring buildings	24" (61 cm)	18" (46 cm)
R = Clearance from corner in recessed location	12" (30 cm)	12" (30 cm)
S = Maximum depth of recessed location	48" (122 cm)	48" (122 cm)
T = Maximum width for back wall of recessed location	24" (61 cm)	24" (61 cm)
U = Horizontal clearance between two terminations that are level	0	0
V = Horizontal clearance (center to center) between two terminations that are not level	18" (46 cm)	18" (46 cm)

Note 1: For N a vent shall not terminate directly above the sidewalk or paved driveway which is located between two single-family dwellings and serve both dwellings.

Note 2: For P only permitted if veranda, porch, deck, or balcony is fully open on a minimum of two sides beneath the floor.

Note 3: For J, K, and as specified in CGA B149 installation code. Local codes or regulations may vary.

* Based on CGA B149.1 Natural Gas and Propane installation code. Local codes may vary, please check with local regulatory agency.

** Based on ANSI Z223.1/NFPA 54 National Fuel Gas Code. Local codes may vary, please check with local regulatory agency.

NOTICE: Venting terminations shall not be recessed into a wall or siding.

VENTING

Install a Simpson DuraVent (Or equivalent) wall thimble, part number 46DVA-WT (not supplied by SÓLAS), where the pipe passes through a wall to retain any insulation in the wall and to maintain proper clearances. If the wall being penetrated is constructed of non-combustible material only (i.e., Masonry block or concrete), the wall thimble is not required; and a hole with zero clearance is acceptable (6 5/8" hole).

This SÓLAS Gas Fireplace has been tested and listed for installation with 4" X 6 5/8" M&G DuraVent GS/Pro®, Selkirk Direct-Temp®, Security Secure Vent™, AmeriVent Direct™, Olympia Ventis®, Metal Fab Direct Vent and ICC EXCELDirect venting components. Although you may use the pipe components (straight pipe, elbows, etc.) from any of the listed manufacturers, you may only use the vent terminations (caps) listed in the chart on this page. For installations where a snorkel is needed, please note that only three snorkels are approved for use. Please plan your installation accordingly.

For all specific venting installation requirements, follow the installation instructions included by the venting manufacturer with the venting system components you have chosen.

PLEASE NOTE

- It is assumed that the installation will include at least one 90° elbow. Up to three additional 90° elbows (or equivalent 45° elbows) may also be used. The total venting may not exceed 30 feet of vertical rise and/or 12 feet horizontal run. Refer to the venting charts on pages 22-23 for specific details while you plan your installation. **Note: The number of elbows impacts the maximum allowable horizontal vent run. Vent runs that exceed 30 feet vertical and/or 12 feet horizontal require a SÓLAS Self-Calibrating Power Vent System.**
- There should be a 1 1/2" overlap of the vent and combustion air tubes when telescopic joints are used.
- The location of the vent termination must meet the requirements of the current edition of ANSI Z223.1/NFPA 54, National Fuel Gas Code or CAN B419.1, Natural Gas and Propane Installation Code and the requirements shown on the previous page of this manual.

APPROVED VENT TERMINATIONS	M&G DURAVENT GS/PRO	SELKIRK DIRECT- TEMP	SECURITY SECURE VENT	AMERIVENT DIRECT VENT	METAL FAB DIRECT VENT	ICC EXCEL DIRECT	OLYMPIA VENTIS
VERTICAL CAP	46DVAVCH	1604802	SV4CGC	4DVC	4DVT	TM4VT	VDV-VCH04 VDV-VC04
HORIZONTAL CAP	46DVAHC 46DVAHRCS 46DVAHSC	1604804	SV4GHC	4DVHC	4DHT	TM4HT TM4DHT	VDV-HC04
SNORKEL	N/A	1604836	N/A	4D36C	N/A	TMST36	N/A

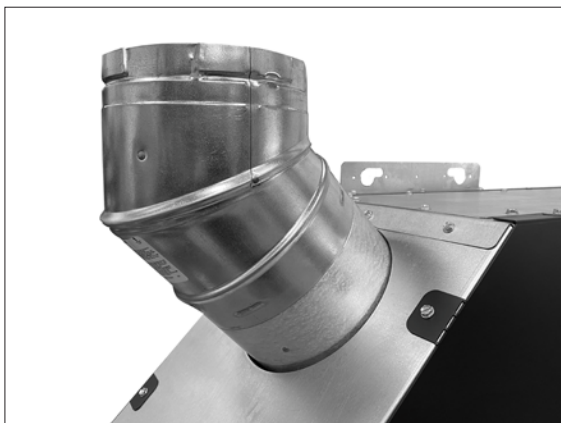

NOTE: The first piece of venting on the fireplace MUST be a 45° elbow either placed completely vertical or horizontal.

This 45° elbow does not get counted in the vent calculations made on the following pages.

VENTING

VENTING WORKSHEET FOR INSTALLER

Use this worksheet to determine the equivalent horizontal run for use with the vent charts on pages 23 and 24. The information contained within this worksheet may also be useful during installation or in the event that you need technical assistance from SÓLAS.

NOTE: Calculations for horizontal or vertical sections of pipe are measured between transition joints as shown in the image below.

Vent runs that are not 90° vertical are considered to have horizontal run but not a vertical rise.

NOTE: Snorkel terminations are counted as (2) 90° elbows.

A. **TOTAL VERTICAL VENT RISE:** Measured as total vertical distance between flanges of elbows used in vent system. (See Diagram) _____ Feet

B. **TOTAL HORIZONTAL VENT RUN:** Measured as total horizontal distance between flanges of elbows used in vent system. (See Diagram) _____ Feet

C. **TOTAL NUMBER OF 90° ELBOWS in excess of 1:** _____ = "C"
NOTE: Snorkel terminations are counted as (2) 90° elbows

D. **TOTAL NUMBER OF 45° ELBOWS in excess of 1:** _____ = "D"

E. **90° Elbow Horizontal Equivalent:** $C \times 3 =$ _____

F. **45° Elbows Horizontal Equivalent:** $D \times 1.5 =$ _____

G. **Total Horizontal Equivalent:** $B + E + F =$ _____

NOTE: Model FORTY8: the minimum vertical rise is a Duravent 46DVA-12 or equivalent.
Model SIXTY0 and SEVENTY2: the minimum vertical rise is a Duravent 46DVA-24 or equivalent.



NOTE: Prior to enclosing the wall cavity, test fire the fireplace to ensure it is fully operational.

VENTING EXAMPLES

EXAMPLE 1 – Model SIXTY0 and SEVENTY2

- A. Total Vertical Vent Rise: 2 feet
 B. Total Horizontal Vent Run: 1 feet
 C. Total Number of 90° Elbows in excess of 1: 0
(Snorkel terminations are counted as (2) 90° elbows)
 D. Total Number of 45° Elbows in excess of 1: 0
 E. 90° Elbow Horizontal Equivalent: $C \times 3 =$ 0
 F. 45° Elbow Horizontal Equivalent: $D \times 1.5 =$ 0
 G. Total Horizontal Equivalent: $B + E + F =$ 1

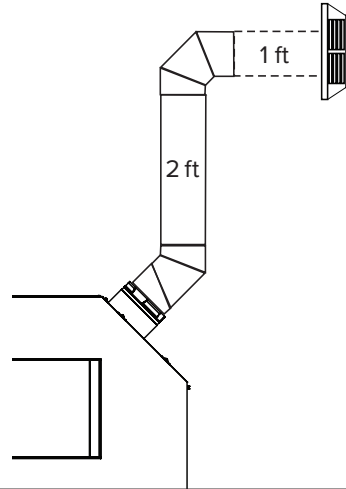

EXAMPLE 2 – Model FORTY8

- A. Total Vertical Vent Rise: 2 feet
 B. Total Horizontal Vent Run: 4 feet
 C. Total Number of 90° Elbows in excess of 1: 1
(Snorkel terminations are counted as (2) 90° elbows)
 D. Total Number of 45° Elbows in excess of 1: 0
 E. 90° Elbow Horizontal Equivalent: $C \times 3 =$ 3
 F. 45° Elbow Horizontal Equivalent: $D \times 1.5 =$ 0
 G. Total Horizontal Equivalent: $B + E + F =$ 7

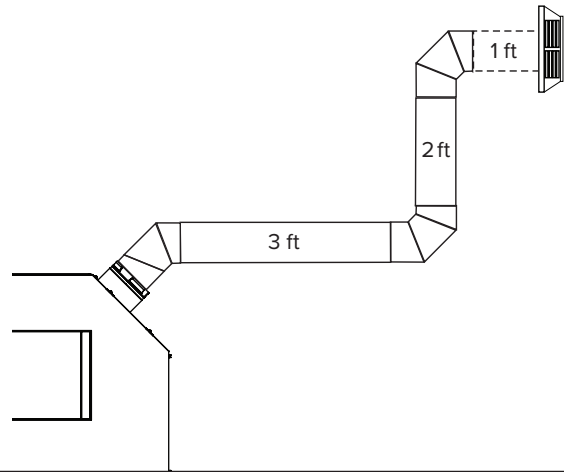

EXAMPLE 3 – Model SIXTY0 and SEVENTY2

- A. Total Vertical Vent Rise: 5 feet
 B. Total Horizontal Vent Run: 6 feet
 C. Total Number of 90° Elbows in excess of 1: 1
(Snorkel terminations are counted as (2) 90° elbows)
 D. Total Number of 45° Elbows in excess of 1: 0
 E. 90° Elbow Horizontal Equivalent: $C \times 3 =$ 3
 F. 45° Elbow Horizontal Equivalent: $D \times 1.5 =$ 0
 G. Total Horizontal Equivalent: $B + E + F =$ 9

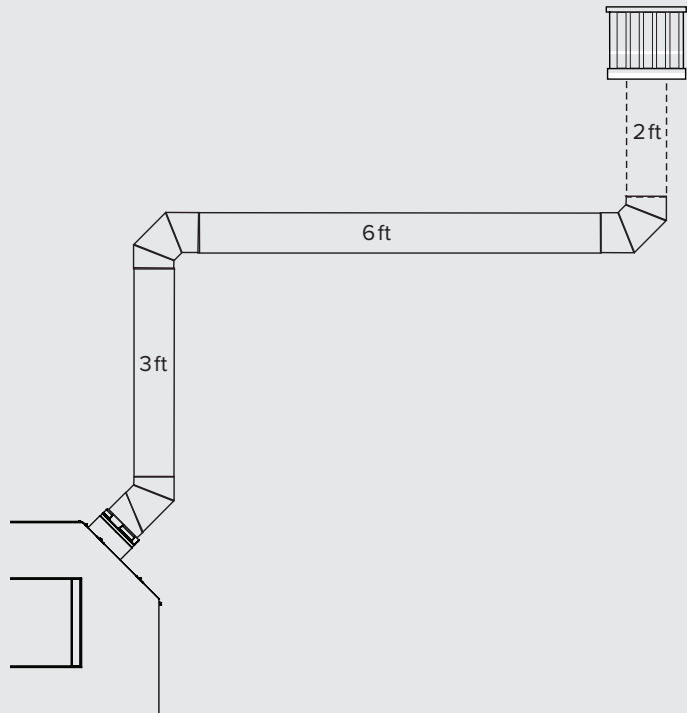

This vent configuration requires a power vent.

9 feet of horizontal equivalent venting requires at least 10 feet of vertical rise to be vented without a power vent.

VENT CHART FOR SÓLAS SIXTY0 AND SEVENTY2

Note: Vent runs that are not 90° vertical are considered to have horizontal run but not a vertical rise. Model SIXTY0 and SEVENTY2: the minimum vertical rise is a Duravent 46DVA-24 or equivalent.

	0	1	2	3	4	5	6	7	8	9	10	11	12	13	14	15
30	GV	GV	GV	GV	GV	GV	GV	GV	GV	GV	GV	GV	GV	GV	PV	PV
29	GV	GV	GV	GV	GV	GV	GV	GV	GV	GV	GV	GV	GV	GV	PV	PV
28	GV	GV	GV	GV	GV	GV	GV	GV	GV	GV	GV	GV	GV	GV	PV	PV
27	GV	GV	GV	GV	GV	GV	GV	GV	GV	GV	GV	GV	GV	GV	PV	PV
26	GV	GV	GV	GV	GV	GV	GV	GV	GV	GV	GV	GV	GV	GV	PV	PV
25	GV	GV	GV	GV	GV	GV	GV	GV	GV	GV	GV	GV	GV	GV	PV	PV
24	GV	GV	GV	GV	GV	GV	GV	GV	GV	GV	GV	GV	GV	GV	PV	PV
23	GV	GV	GV	GV	GV	GV	GV	GV	GV	GV	GV	GV	GV	GV	PV	PV
22	GV	GV	GV	GV	GV	GV	GV	GV	GV	GV	GV	GV	GV	GV	PV	PV
21	GV	GV	GV	GV	GV	GV	GV	GV	GV	GV	GV	GV	GV	GV	PV	PV
20	GV	GV	GV	GV	GV	GV	GV	GV	GV	GV	GV	GV	GV	GV	PV	PV
19	GV	GV	GV	GV	GV	GV	GV	GV	GV	GV	GV	GV	GV	GV	PV	PV
18	GV	GV	GV	GV	GV	GV	GV	GV	GV	GV	GV	GV	GV	GV	PV	PV
17	GV	GV	GV	GV	GV	GV	GV	GV	GV	GV	GV	GV	GV	GV	PV	PV
16	GV	GV	GV	GV	GV	GV	GV	GV	GV	GV	GV	GV	GV	GV	PV	PV
15	GV	GV	GV	GV	GV	GV	GV	GV	GV	GV	GV	GV	GV	GV	PV	PV
14	GV	GV	GV	GV	GV	GV	GV	GV	GV	GV	GV	GV	GV	GV	PV	PV
13	GV	GV	GV	GV	GV	GV	GV	GV	GV	GV	GV	GV	GV	GV	PV	PV
12	GV	GV	GV	GV	GV	GV	GV	GV	GV	GV	GV	GV	GV	GV	PV	PV
11	GV	GV	GV	GV	GV	GV	GV	GV	GV	GV	GV	PV	PV	PV	PV	PV
10	GV	GV	GV	GV	GV	GV	GV	GV	GV	GV	GV	PV	PV	PV	PV	PV
9	GV	GV	GV	GV	GV	GV	GV	GV	GV	GV	PV	PV	PV	PV	PV	PV
8	GV	GV	GV	GV	GV	GV	GV	GV	GV	GV	PV	PV	PV	PV	PV	PV
7	GV	GV	GV	GV	GV	GV	GV	GV	GV	PV	PV	PV	PV	PV	PV	PV
6	GV	GV	GV	GV	GV	GV	GV	GV	GV	PV	PV	PV	PV	PV	PV	PV
5	GV	GV	GV	GV	GV	GV	GV	GV	GV	PV	PV	PV	PV	PV	PV	PV
4	GV	GV	GV	GV	GV	GV	GV	GV	GV	PV	PV	PV	PV	PV	PV	PV
3	GV	GV	GV	GV	PV	PV	PV	PV	PV	PV	PV	PV	PV	PV	PV	PV
2	GV	GV	GV	PV	PV	PV	PV	PV	PV	PV	PV	PV	PV	PV	PV	PV
1	GV	PV	PV	PV	PV	PV	PV	PV	PV	PV	PV	PV	PV	PV	PV	PV
0	NA	PV	PV	PV	PV	PV	PV	PV	PV	PV	PV	PV	PV	PV	PV	PV

VERTICAL VENT RUN (Ft)
Line item A on Venting Worksheet

HORIZONTAL VENT RUN (Ft)
Line item G on Venting Worksheet

NA = NOT ALLOWED
 GV = GRAVITY VENT
 PV = POWER VENT

Power vent runs of up to 130ft with (8) 90° elbows are permitted when using the SÓLAS Self-Calibrating Power Vent Kit. Refer to power vent instructions for additional power vent installation and operation information.

SCREEN REMOVAL

1. Lift up on the two front tabs of the lower air trim panel to remove it from the fireplace opening.



Tabs on Lower Air Trim Panel

2. Remove the left and right side panels by lifting up and toward you.

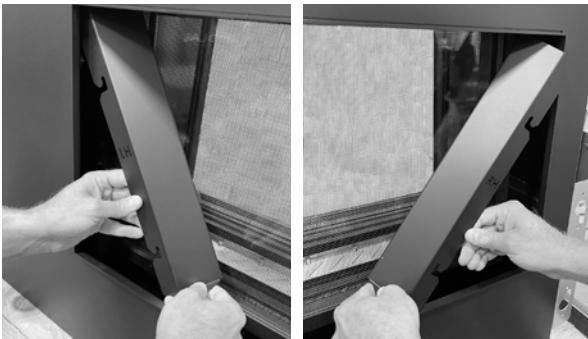

3. The fireplace screen is held in place by 3 self-tensioning latches along its top edge (4 Latches on the **SEVENTY2**). Release these latches to remove the screen.



4. Allow the screen to rest in the fireplace opening, confirm that the latches are in the "home" position and engaging the latch magnets.



5. Lift the screen up so that the bottom of the screen clears the bottom of the fireplace opening.



6. Angle the screen toward you from the bottom to remove.

To reinstall the screen, reverse these steps. Remember to confirm the latches are in the "Home" position any time you are installing or removing the screen.

NOTICE: If this screen is removed for servicing the appliance, it must be replaced prior to operating the appliance.

FINAL ASSEMBLY

GLASS REMOVAL

NOTE: Glass removal and installation for the Slim-Line Built-In models is a 2-person operation using suction cups.

1. With the lower air panel and screen removed (see previous page), loosen the ¼" - 20 bolts along the top edge of the glass frame using a 7/16" socket.

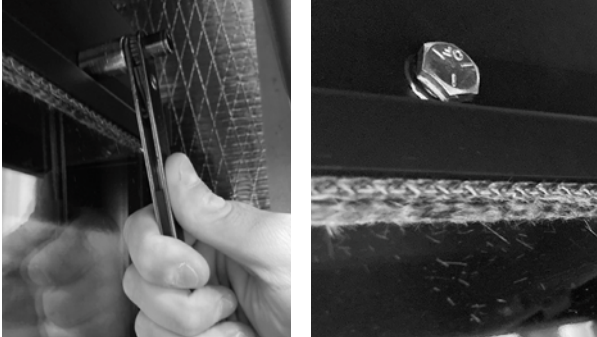

2. Confirm that the Screen latches are in their "home" position and engaging the latch magnets.



3. Lift the glass frame assembly up so that the bottom of the glass frame assembly clears the bottom of the fireplace opening.



4. Angle the glass assembly toward you from the bottom to remove.



Refer to the next page for instructions on burner media placement.

GLASS INSTALLATION

1. Insert the glass frame assembly into the fireplace by angling the top of the glass in and up into the fireplace.



2. Lift the glass frame assembly up so that the bottom of the glass frame assembly clears the bottom of the fireplace opening.
3. Slide the glass frame into the glass frame retainer along the bottom of the firebox opening.
4. Install the ¼" - 20 bolts along the top edge of the glass frame assembly and tighten using a 7/16" socket.

NOTICE: DO NOT attempt to operate the fireplace without the screen or glass frame assembly in place. Doing so could lead to injury, property damage, or loss of life.

PLACING THE BURNER GLASS MEDIA

The burner glass media poly-bag that you set aside when you unpacked the fireplace contains the correct amount of glass material to cover the burner. **DO NOT** add any additional media to the media supplied with your fireplace. The entire contents of the bag should be evenly distributed over the burner tray.

1. Locate the burner in the fireplace. Refer to the adjacent illustration.
2. Carefully clip one corner of the poly-bag to form a pouring spout. The opening should be large enough to allow the glass media to flow but not so large that you can't control the flow.
3. You will notice that the burner surface is designed with turned-up edges that form a tray to hold the glass media.
4. Starting at one end, pour the glass media onto the burner tray, keeping the pouring spout on the poly-bag toward the center of the burner to avoid spillage of glass pieces over the sides of the burner. See the adjacent illustrations.
5. Once you have poured all of the glass burner media into the burner tray, carefully smooth the glass pieces out so they have a uniform depth over the entire surface of the burner. When the burner glass media is properly placed, it should look like the images here on the right.

Note: If a few pieces of glass escape over the edges of the burner tray during installation, it is not a problem. They will simply land in the area below the burner and will do no harm.

Optional Birch Log Set Available

Refer to separate Log Set Manual for assembly.



Burner Tray



Burner Glass Media – Partially Installed



Burner Glass Media – Fully Installed

FINAL ASSEMBLY

Just as with any other vented device, vertical vent rise creates draft (negative pressure) in the firebox as the exhaust gases heat up. If this draft becomes excessive, it can affect the performance or appearance of the fire. The SÓLAS Gas Fireplace includes an integrated air restrictor that can be used to balance the draft in the fireplace to the optimal level for installations where excessive draft might occur. The SÓLAS Gas Fireplace will ship from the factory with the air restrictor set to the #1 position. If the licensed fireplace installer determines that draft reduction is necessary, loosen the fastener on the dial and make small adjustments from #1 to #4 until a satisfactory result has been achieved.

The air restrictor dial is located on the flue side of the firebox when viewed from the front. To access, remove the lower air screen and side panels. Once satisfied with the air restrictor adjustment, secure its position by tightening all hardware.

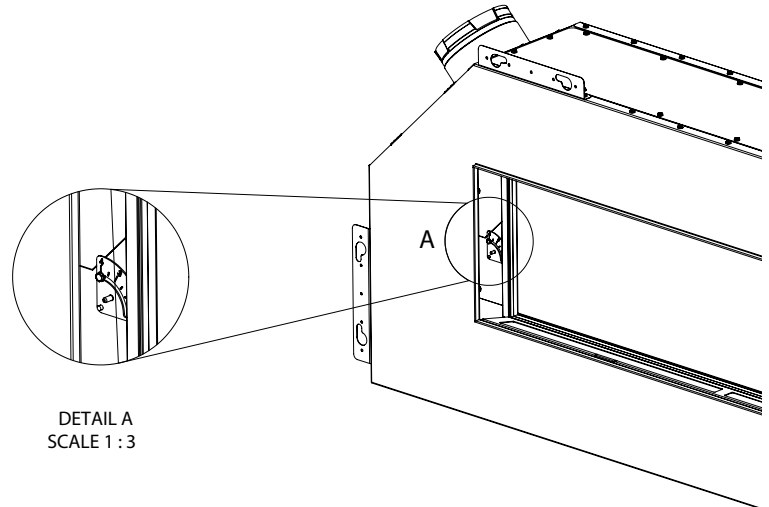

DETAIL A
SCALE 1:3

SÓLAS Flue Restrictor Kit, Part #11210

Some vent configurations may create excess draft within the fireplace. Excess draft can cause issues such as a rapid, or “nervous” flame picture, undesirable flame color, or pilot lifting which may prevent the fireplace from staying lit. In these circumstances it may be necessary to install the flue restrictor kit part #11210 in the venting system. It is permissible to install this restrictor at the vent cap should the venting system already be installed. Secure the restrictor plate with the included #10 sheet metal screws.

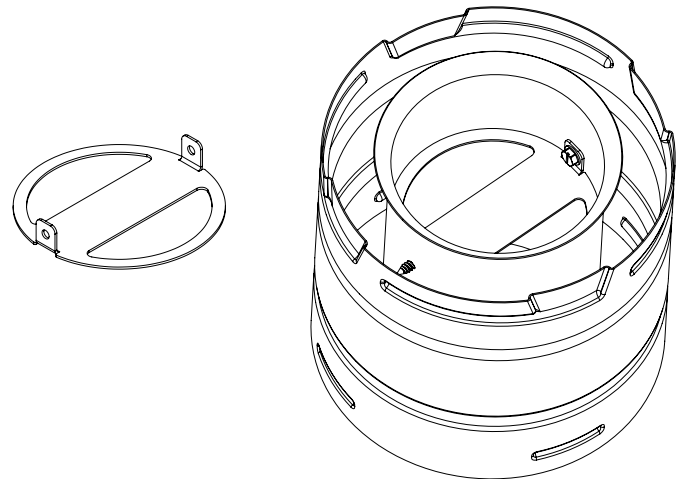

SÓLAS FORTY8 Flue Baffle Kit, Part #11273

Certain vent configurations for the SÓLAS FORTY8, particularly those with a significant amount of vertical in relation to the amount of horizontal vent pipe, may cause the flame to be unbalanced, or biased toward the flue outlet side of the fireplace. Installation of this flue baffle, part #11273, will help to resolve this issue. It may be necessary to use this restrictor on its own, or in addition to the SÓLAS flue restrictor kit, part #11317 shown above. This flue baffle kit snaps into the fireplace as shown below. **For use in FORTY8 Slim-Line Built-In Models only.**

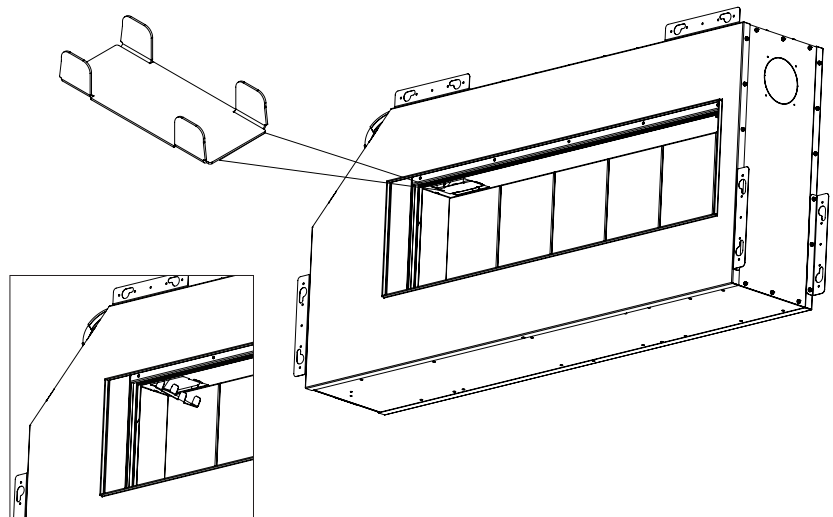

FIRST FIRE INSTRUCTIONS

When operating your new fireplace for the first time, some vapors may be released due to the curing compounds used in the manufacture of the appliance. They may cause a slight odor and could cause the flames to be the full height of the firebox, or even slightly higher, for the first few hours of operation. It is possible that these vapors could set off smoke detection alarms in the immediate vicinity. These vapors are quite normal on new appliances. We recommend opening a window to vent the room during the burn off period. After a few hours use, the vapors will have disappeared and the flames will be at their normal height.

It is important that the Comfort Blower is turned on to help clear the vapors from the unit.

Follow these instructions for a successful first fire;

1. Turn the fireplace on in Manual Mode.
2. Set flame height to HI.
3. Set the Comfort Blower speed control to level
4. Let the fireplace run for **3 hours** at this setting then shut off fireplace and let it cool.
5. After the fireplace cools, turn the fireplace on in manual mode with flame on HI and the Comfort Blower off.
6. Allow fireplace to run for **6 hours** in this setting.

NOTE: Slight Odors may still be noticed on future uses of the fireplace but will diminish over time. The type of finishing materials used around the fireplace may add odors or add to the curing time. If the fireplace has not been used in several months, it is normal for odors to occur caused by lint or dust that has settled on the unit while not in use.

FLAME SUPERVISION DEVICE

For your safety, this appliance is fitted with a flame supervision device which will shut-off the gas supply if, for any reason, the pilot flame goes out. This device incorporates a fixed probe, which senses the heat from the pilot flame. If the probe is cool, the device will prevent any gas flow unless manually lighting the pilot. See full lighting instructions.

NOTE: Periodically conduct a visual check to ensure the pilot and burner flames are as shown (top of page 31).

During extreme cold weather, it is recommended that you leave the pilot running to prevent condensation forming in the firebox and on the glass viewing area during startup.

LIGHTING, OPERATION & RATING INFO

The Lighting, Operation and Rating information is located on a plate in front of the Comfort Blower inside the front face of the fireplace.

To access the plate, remove lower air trim panel as shown in step 1 on page 26.

⚠ WARNING

DO NOT ATTEMPT TO TOUCH THE DATA PLATE WHILE THE FIREPLACE IS STILL HOT!
Let the fireplace cool first before touching it.

SERVICING

If any attention is required for your appliance, contact your dealer quoting the model number and serial number. This number is on the rating plate, which is located adjacent to the control module. The replacement parts are shown at the end of this manual. Please always quote the part number and description when requesting spare parts. Warranty is void if serviced by a non-qualified technician.

FIREPLACE CONTROL DEVICES

There are two ways to control your fireplace.

1. SÓLAS One-Touch Remote (**S-507**)
2. Optional Wall Touch Pad (**WTP-1500**)

The SÓLAS One-Touch Remote can be programmed to function automatically—see pages 34-38.

The Optional Wall Touch Pad can be used to turn the flame on, off, and to increase or decrease the flame height.

NOTE: The SÓLAS One-Touch Remote in the AUTO mode will override the Wall Touch Pad.

NOTE: The Wall Touch Pad is not compatible with the SÓLAS Self-Calibrating Power Vent System.

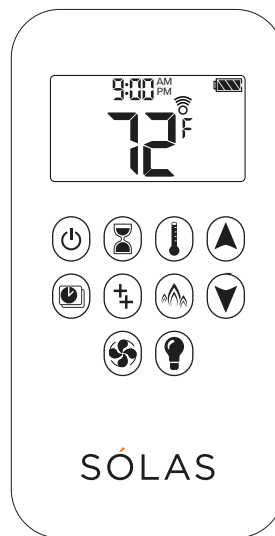

SÓLAS One-Touch Remote Part #S-507

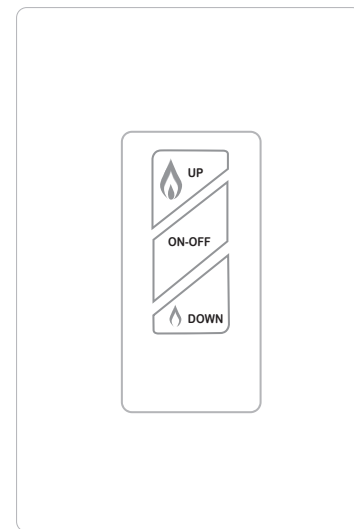

Wall Touch Pad Part #WTP-1500 (Optional)

LIGHTING & OPERATION

WARNING: If you do not follow these instructions exactly, a fire or explosion may result causing property damage, personal injury or loss of life.

When lighting this appliance, follow instructions exactly.

- A. This appliance is equipped with an ignition device that automatically lights the pilot. Do not try to light the pilot by hand.
- B. BEFORE OPERATING THE BURNER SYSTEM, smell around the appliance area for gas. Be sure to smell next to the floor because some gas is heavier than air and will settle on the floor.

WHAT TO DO IF YOU SMELL GAS

- Do not try to light the appliance.
 - Do not touch any electric switch; do not use any telephone in your building.
 - Immediately call your gas supplier from a neighbor's telephone. Follow the gas supplier's instructions
 - If you cannot reach your gas supplier, call the fire department.
- C. Use only your hand to operate the gas controls. Never use tools. If a knob will not push in or turn by hand, don't try to repair it, call a qualified service technician. Force or attempted repair may result in a fire or explosion.
- D. Do not use this appliance if any part has been under water. Immediately call a qualified service technician to inspect the appliance and to replace any part of the control system which has been under water.

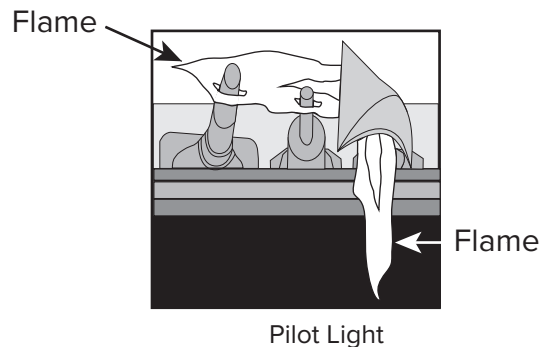

Pilot Light Location

NOTE: If the pilot does not stay lit after several tries, proceed to step 9.

7. Use the flame height adjustment buttons on either the Remote or the optional Wall Touch Pad to adjust the flame. To increase flame height, press and hold ▲. To decrease flame height, press and hold ▼.
8. Press and hold the ▼ button on the Remote or optional Wall Touch Pad to set the appliance to Pilot flame only.
9. If the appliance will not operate, follow the instructions "TO TURN OFF GAS TO THE APPLIANCE" and call your gas service technician or gas supplier.

TO TURN OFF GAS TO THE APPLIANCE

1. To turn off gas to the appliance, push and release the "OFF" button on either the Remote or the optional Wall Touch Pad. An audible signal will confirm.
2. TO TURN OFF THE GAS SUPPLY TO THE APPLIANCE, close the shut-off valve on the gas supply line to the appliance.

OPERATING INSTRUCTIONS

1. STOP! Read the safety information above on this label.
2. This appliance is equipped with an ignition device that automatically lights the pilot. Do not try to light the pilot by hand.
3. Confirm that the remote LCD display says "OFF". Visually check there is no pilot flame visible inside the fireplace.
4. Wait five (5) minutes to clear out any gas. Then smell for gas including near the floor. If you smell gas, STOP! Follow "B" in the safety information above. If you don't smell gas, proceed to step 5.
5. Using either the Remote or the optional Wall Touch Pad, press and hold the "ON/OFF" button for 4 seconds. An audible signal confirms the start sequence has begun.
6. Continuing beeps confirm the ignition is in process. Once lighting the pilot flame should appear as shown below. Once the pilot is confirmed, the main burner ignites on high.

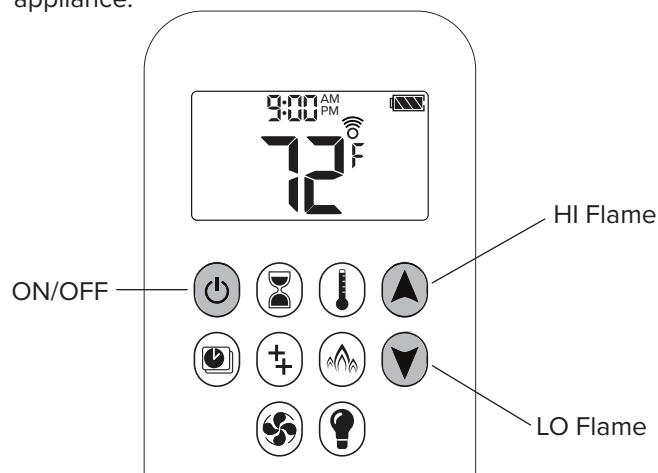

SÓLAS ONE-TOUCH REMOTE PAIRING SET-UP

The Control Module and the Remote must be paired before the first use. This has been completed for you at the factory. Refer to the section below if the Control Module and Remote lose synchronization.

1. Insert two AAA alkaline batteries in the Remote. Only use brand name alkaline batteries, such as Duracell or Energizer.
2. Four AA alkaline batteries are installed in the Control Module (shown below).

NOTE: The four AA batteries are only used for battery backup purposes in the event of a power outage.

3. Locate the RESET button on the front side of the Control Module.
4. Press and hold the Control Module's RESET button until you hear one short beep and one long beep. After the second beep, release the reset button.
5. Within the subsequent 20 seconds, press and hold the  button on the Remote for 2-3 seconds. **CONN** will be displayed and flash on the Remote during the pairing sequence. The Remote will count up from 1 to 8, and you will hear two short beeps confirming the pairing is complete.

If you hear one long beep, the pairing sequence has failed or the wiring is incorrect.

This is a one-time pairing and is not required when changing the batteries of the Remote or Control Module. The remote control system is now ready to use.

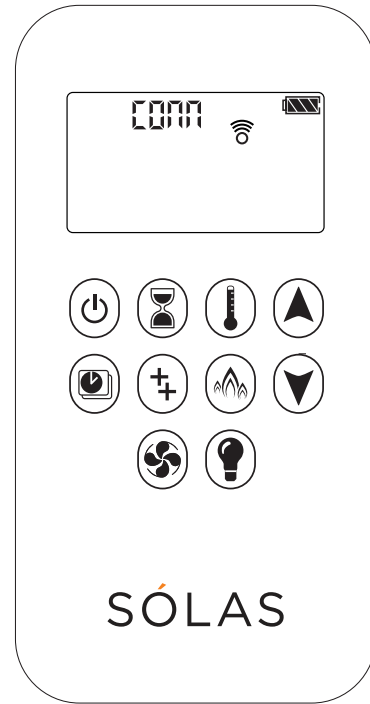

SÓLAS One-Touch
Programmable
Thermostatic Remote
Part #S-507

NOTE: The batteries in your SÓLAS One-Touch remote control and control module are to be replaced annually.



RESET Button

SÓLAS One-Touch
Module de Controle
Part #S-504

SÓLAS ONE-TOUCH REMOTE OPERATION

HOW TO TURN YOUR FIREPLACE OFF (INCLUDING PILOT)

Familiarize yourself with each of these methods before operating your fireplace.

Remote and Wall Touch Pad*: Press and hold the ON-OFF button for a second (either on the Remote or the optional Wall Touch Pad).

If the flames are on, they go down and you hear the valve motor wind down. You hear a clunk and a beep indicating that the valve has received the signal from the Remote.

HOW TO ENSURE YOUR FIREPLACE CANNOT BE TURNED ON INADVERTENTLY

You can use the following method to ensure that your fireplace will not turn on when you don't want it on.

First, ensure your fireplace is turned off—including the pilot—and cold BEFORE going ahead.

- Close the shut-off valve on the gas supply line to the appliance.
- Remove all batteries from the Control Module as well as the batteries from the Remote.
- Shut off power at the breaker.

Automatic Shut-Off (in certain conditions)

Your fireplace's Remote is equipped with an automatic shut-off mechanism which is activated in certain conditions. See page 38 in the Remote Control Operation section for a description of this feature.

NOTE: Before using the remote control system for the first time, the Control Module and the Remote are synchronized at the factory. See the section SÓLAS Remote Pairing Set-up on page 32 of this manual if the Control Module and Remote lose synchronization.

IMPORTANT: BEFORE YOU BEGIN, please note that with this system, the settings of time, temperature and automatic ON/OFF can only be programmed when the function display is flashing. Be patient when programming as it does take time to set-up.

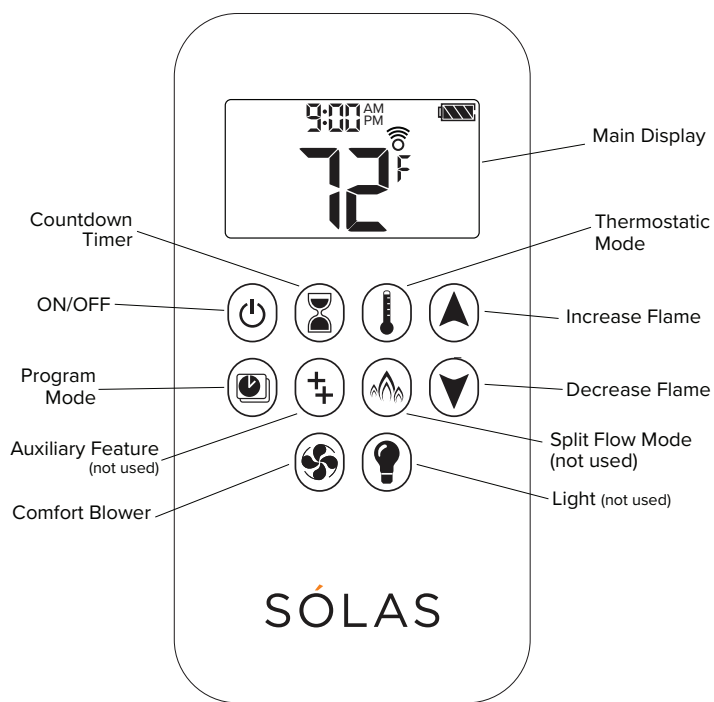

SÓLAS One-Touch
Programmable
Thermostatic Remote
Part #S-507

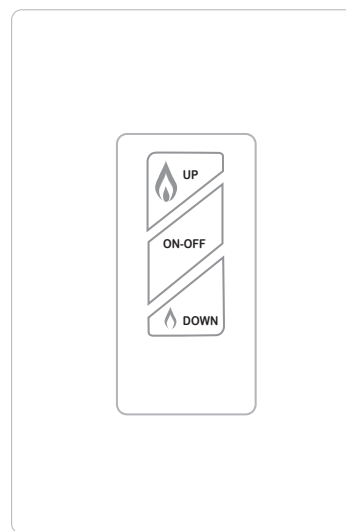

SÓLAS Wall Touch Pad*
(Optional)
Part #WTP-1500

*Not Compatible with SÓLAS Self-Calibrating Power Vent Kit

SÓLAS

ONE-TOUCH REMOTE MAIN DISPLAY OVERVIEW

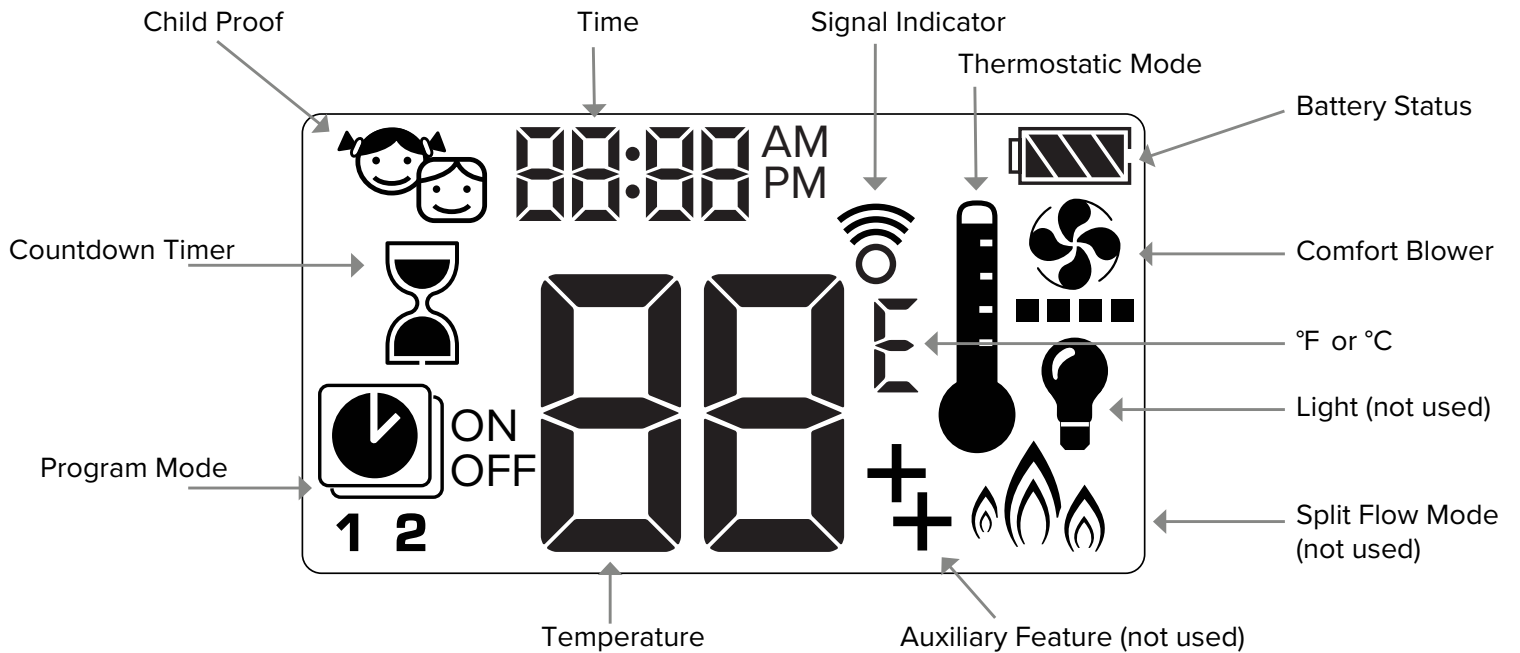

DO NOT leave the Remote on the hearth, mantel, or on top of the fireplace. Use the Remote wall mount holder provided.

SÓLAS ONE-TOUCH REMOTE OPERATION

TO TURN ON FIREPLACE

CAUTION

WHEN PILOT IGNITION IS CONFIRMED, MOTOR TURNS AUTOMATICALLY TO MAXIMUM FLAME HEIGHT.

One-Touch Lighting (default): 

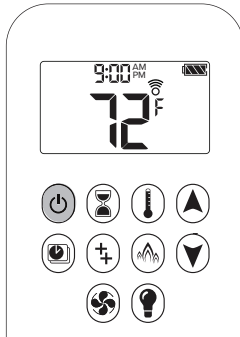



Press and hold  for 4 seconds, until 8 short beeps and a blinking series of lines confirms the start sequence has begun. Release button.

Main gas flows once pilot ignition is confirmed.

Remote automatically goes into manual mode after main burner ignition. The fireplace will default to HI flame.

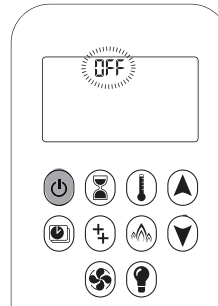
TO TURN OFF FIRE



- Press  to turn OFF. When the pilot is off, it will take 2 minutes before it can be lit again.

NOTE: There is a 2 minute delay after switching off before the next ignition is possible.

CAUTION

Always check the fire and pilot visually to ensure they are off.

STANDBY MODE (PILOT FLAME)

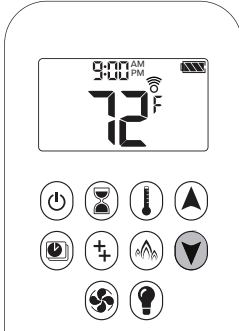

Press and hold  to set appliance to pilot flame.

FLAME HEIGHT ADJUSTMENT



To increase flame height, press and hold .

To decrease flame height, press and hold . You may hold the button down until the fire is set to pilot flame only.

CAUTION

If the pilot does not stay lit after several tries call your local service technician or gas supplier.

DESIGNATE LOW AND HIGH FIRE

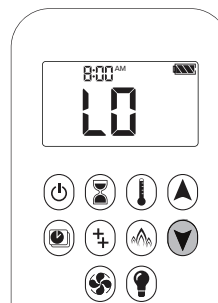

Double-Click DOWN Arrow  button. "LO" is displayed.

NOTE: Flame goes to high fire first before going to designated low fire.

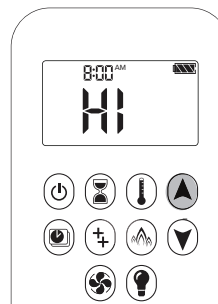

Double-Click UP Arrow  button. Flame automatically goes to high fire. "HI" will be displayed.

SÓLAS ONE-TOUCH REMOTE OPERATION

SETTING CELSIUS OR FAHRENHEIT

To change between °C and °F, press and hold + simultaneously.

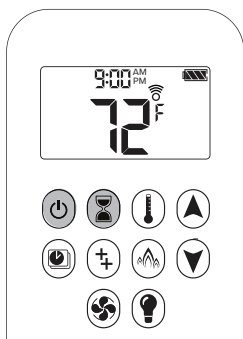

Note: When Remote is in °C (Celsius) mode the clock will be 24-hour. When Remote is in °F (Fahrenheit) mode the clock will be 12-hour.

SETTING THE TIME

1. Press + simultaneously. **Day** flashes.
2. Press + to select a number to correspond with the day of the week.
 - 1 = Monday
 - 2 = Tuesday
 - 3 = Wednesday
 - 4 = Thursday
 - 5 = Friday
 - 6 = Saturday
 - 7 = Sunday
3. Press + simultaneously. **Hour** flashes.
4. To select hour press or .
5. Press + simultaneously. **Minutes** flash.
6. To select minutes press or .
7. To confirm, press + simultaneously or wait.

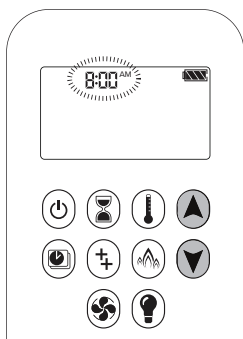

CHILD PROOF

Your Remote can be set to lock out all commands to the fireplace, except OFF.

To turn Child Proof ON:

1. Press and hold + simultaneously.
2. is displayed. Child Proof is now active.

To turn Child Proof OFF:

1. Press and hold + simultaneously.
2. disappears. Child Proof is now inactive, and the Remote has full function.

COUNTDOWN TIMER

You can set your fireplace to automatically turn off at the end of a timer.

To set a Countdown Timer:

1. Press and hold until is displayed. **Hour** flashes.
2. Press or to select Hour.
3. To confirm, press . **Minutes** flash.
4. Press or to select Minutes.
5. To confirm, press or wait.

To turn off a Countdown Timer:

1. Press , and the countdown disappears.

NOTE: The Countdown Timer only works in Manual and Thermostatic modes. Maximum countdown time is 9 hours and 50 minutes.

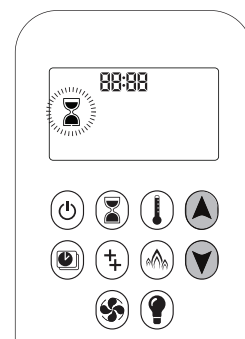

COMFORT BLOWER OPERATION

Setting:

1. Press and hold until flashes.
2. Press to increase or to decrease Comfort Blower speed.
3. To confirm setting, either press or wait. is displayed.

OFF: Press until all 4 speed level bars disappear.

NOTE: When setting, if the Comfort Blower was not switched off after last use, it starts automatically 4 minutes after ignition at maximum speed, and goes to the last set level after 10 seconds. The Comfort Blower stops 10 minutes after the main burner is extinguished.

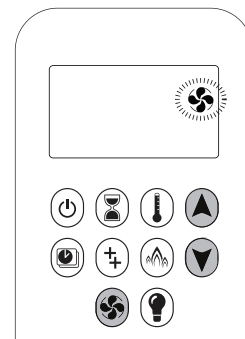

SÓLAS ONE-TOUCH REMOTE OPERATION

MODES OF OPERATION

Manual Mode

The ON/OFF status of the fireplace, as well as flame height, are manually controlled by the user.

Thermostatic Mode

The room temperature is measured and compared to the set temperature. The flame height is automatically adjusted to achieve the set temperature.

ON:

Press . is displayed. Preset temperature displays briefly, followed by the room temperature.

Setting Desired Temperature:

1. Press and hold until is displayed and set temperature flashes.
2. To adjust set temperature, press or .
3. To confirm, press or wait.

OFF:

1. Press .
2. Press or to go to Manual Mode.
3. Press to go to Program Mode.

Program Mode

The temperature is controlled by Programs 1 and 2, each of which can be set to go on and off at specific times, at a set temperature.

PROGRAM MODE

ON:

Press . , 1 or 2, **ON** or **OFF** are displayed.

OFF:

1. Press , or to go to Manual Mode.
2. Press to go to Thermostatic Mode.

NOTE: The set temperature for Thermostatic Mode is the temperature for the ON time in Program Mode. Changing the Thermostatic Mode set temperature also changes the ON time temperature in Program Mode.

Default Settings:

- ON TIME (Thermostatic) TEMPERATURE: 70°F / 21°C
- OFF TIME TEMPERATURE: " " (pilot flame only)

Temperature Setting:

1. Press and hold until flashes. **ON** and set temperature (set in Thermostatic Mode) is displayed.
2. To continue, press or wait. , **OFF** displayed, temperature flashes.
3. Select off temperature by pressing or .
4. To confirm, press .

NOTE: The ON (Thermostatic) and OFF set temperatures are the same for each day.

Day Setting:

1. ALL flashes. Press or to choose between:
 - **ALL** = same settings ON-OFF every day
 - **SA:SU** = same settings ON-OFF Saturday and Sunday
 - **1, 2, 3, 4, 5, 6, 7** = daily timer—unique ON-OFF settings for a single day of the week, for multiple days of the week, or every day of the week.
2. To confirm, press .

ALL Selected

On Time Setting (PROGRAM 1)

1. , **1**, **ON** are displayed. **ALL** is displayed briefly. Hour flashes.
2. To select hour, press or .
3. To confirm, press . , **1**, **ON** are displayed. **ALL** displayed briefly. Minutes flash.
4. To select minutes, press or .
5. To confirm, press .

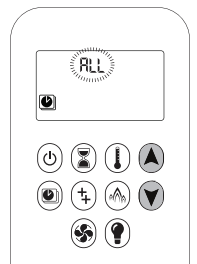
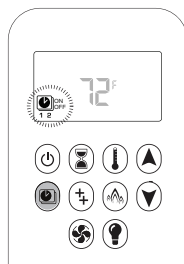
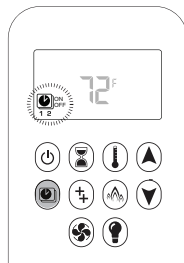
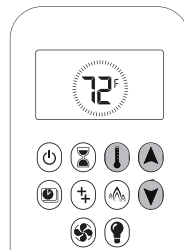
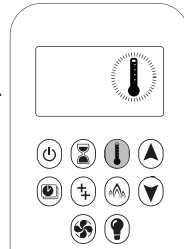

SÓLAS ONE-TOUCH REMOTE OPERATION

PROGRAM MODE (Continued)

Off Time Setting (PROGRAM 1)

1. , **1, OFF** are displayed. ALL is displayed briefly. Hour flashes.
2. To select hour, press or .
3. To confirm, press . , **1, OFF** are displayed. **ALL** displayed briefly. Minutes flash.
4. To select minutes, press or .
5. To confirm, press .

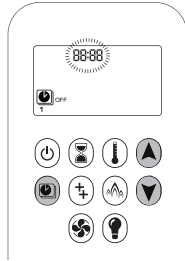

NOTE: Either continue to PROGRAM 2 and set ON and OFF times or stop programming at this point, and PROGRAM 2 remains deactivated.

NOTE: PROGRAM 1 and 2 use the same ON (Thermostatic) and OFF temperatures. Once a new ON (Thermostatic) and/or OFF temperature has been set, that temperature becomes the new default setting.

NOTE: ON and OFF times programmed for PROGRAM 1 and PROGRAM 2 become the new default times.

The batteries must be removed to clear the PROGRAM 1 and PROGRAM 2 ON and OFF times and temperatures.

SA: SU or Daily Timer (1-7) Selected

- Set ON time and OFF time using the same procedure as “**ALL Selected**” above.
- Waiting to finish setting.

LOW BATTERY INDICATION

CAUTION

Do not use a screwdriver or other metallic object to remove the batteries from the Control Module battery holder or the Remote. This could cause a short circuit.

NOTE: The batteries in your SÓLAS One-Touch remote control and control module are to be replaced annually. Only use brand-name alkaline batteries such as Duracell or Energizer.

Remote

The battery icon will show when the battery needs to be replaced. Replace with two 1.5 V AAA alkaline batteries.

Control Module

Frequent beeps for 3 seconds when the motor turns indicate the batteries in the battery holder of the Control Module need to be replaced. Replace with four 1.5 V AA alkaline batteries.

AUTOMATIC SHUT-OFF

Countdown Timer

At the end of countdown time period, the fire turns off. The Countdown Timer only works in Manual and Thermostatic. Maximum countdown time is 9 hours and 50 minutes.

Seven Day Shut Off

If there is no activity for 7 days, the SÓLAS fireplace will automatically shut down the pilot as required by certain jurisdictions.

AUTOMATIC TURN DOWN



3 Hour No Communication Function

If your fireplace and remote are inactive for three hours—for example, if the remote is left in another room—your fireplace automatically turns down to pilot.

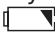

Benefit

SÓLAS products are designed with a focus on safety and environmental responsibility. This will help save fuel and is an environmental benefit. Program the temperature and timer modes to maximize your heating efficiency.

SÓLAS ONE-TOUCH REMOTE OPERATION

ERROR CODE	MESSAGE	DURATION OF DISPLAY	SYMPTOM	POSSIBLE CAUSE
F04	F04	4 seconds	<ul style="list-style-type: none"> No pilot flame within 30 sec Note: After 3 failed ignition sequences, F06 shown 	<ul style="list-style-type: none"> No gas supply Air in pilot supply line No spark Reversed polarity in thermocouple wiring
F06	F06	4 seconds	<ul style="list-style-type: none"> 3 failed ignition sequences in 5 minutes Fire is not responding, no pilot flame 	<ul style="list-style-type: none"> No gas supply Air in pilot supply line No spark Reversed polarity in thermocouple wiring Incorrect pilot orifice if valve has been converted from LPG to NG or vice versa
F07	Low Battery Symbol 	Permanent	<ul style="list-style-type: none"> Battery icon flashes on Remote display 	<ul style="list-style-type: none"> Low battery in Remote
F09	F09	4 seconds	<ul style="list-style-type: none"> Fire is not responding No electronic control of fire 	<ul style="list-style-type: none"> Down arrow button  was not pressed during pairing Control Module and Remote are not synced
F46	F46	4 seconds	<ul style="list-style-type: none"> Fire is not responding Intermittent response No electronic control of fire 	<ul style="list-style-type: none"> No or bad connection between Control Module and Remote No power at Control Module Low communication range (Control Module Faulty, Remote not communicating with Control Module)

SÓLAS ONE-TOUCH REMOTE TIPS

- Double-click  to go directly to **LO** (lowest) flame setting.
- Double-click  to go directly to **HI** (highest) flame setting.
- The batteries in your SÓLAS one touch remote control and control module are to be replaced annually. Only use brand name alkaline batteries such as Duracell or Energizer.
- When using the Remote, it should be within 15 feet (4.5 meters) of the fireplace.
- Don't leave the Remote on the mantel or hearth or any hot surfaces. Use the Remote wall holder provided.
- To keep out of children's reach, use the Remote wall holder provided.
- Be patient when programming: it takes time to set-up.
- Once you turn a pilot off, it takes a few minutes before you can turn it back on.

Your SÓLAS Dealer is here to help if you have any trouble with your SÓLAS Fireplace or SÓLAS One-Touch Remote. Please contact your Dealer for support.

GAS CONVERSION

SÓLAS appliances are shipped from the factory ready for Natural Gas and are field convertible to Propane when a SÓLAS gas conversion kit is used. Gas conversions must be performed by a qualified service technician, or licensed gas fitter where local code requires. Installation must be performed by a licensed service technician, if not the warranty is void.

SÓLAS Gas Fireplaces are approved for installation at elevations up to 2000 feet in the U.S. and 1370 meters (4500 feet) in Canada without change. If your installation is at an elevation greater than those noted, consult with the local authority having jurisdiction for gas product installations to determine their specific requirements for high altitude installations.

PART #	DESCRIPTION	SÓLAS CONVERSION KIT CONTENTS		
48BI-LPC	FORTY8 LP CONVERSION KIT	#27 PILOT ORIFICE	#52 LP BURNER ORIFICE – 1PC	Gas Conversion Label
48BI-NGC	FORTY8 NG CONVERSION KIT	#35 PILOT ORIFICE	#42 NG BURNER ORIFICE – 1PC	NG INLET TUBE COLLAR – 1PC #8 SCREW – 2PCS Gas Conversion Label
60BI-LPC	SIXTY0 LP CONVERSION KIT	#27 PILOT ORIFICE	#56 LP BURNER ORIFICE – 2PCS	Gas Conversion Label
60BI-NGC	SIXTY0 NG CONVERSION KIT	#35 PILOT ORIFICE	#49 NG BURNER ORIFICE – 2PCS	NG INLET TUBE COLLAR – 2PCS #8 SCREW – 2PCS Gas Conversion Label
72BI-LPC	SEVENTY2 LP CONVERSION KIT	#27 PILOT ORIFICE	#55 LP BURNER ORIFICE – 2PCS	Gas Conversion Label
72BI-NGC	SEVENTY2 NG CONVERSION KIT	#35 PILOT ORIFICE	#46 NG BURNER ORIFICE – 2PCS	NG INLET TUBE COLLAR – 2PCS #8 SCREW – 2PCS Gas Conversion Label

- The burner(s) are retained by #10 sheet metal screws. Using a 5/16" nut driver, remove screws located below the burner (in front of and behind burner).
Note: The FORTY8 and SIXTY0 models have 8 screws, and the SEVENTY2 models have 12 screws.



- The SIXTY0 and SEVENTY2 models have a center burner link that aligns the burners, remove the #10 sheet metal screws using a 5/16" nut driver.



- Remove pilot hood.

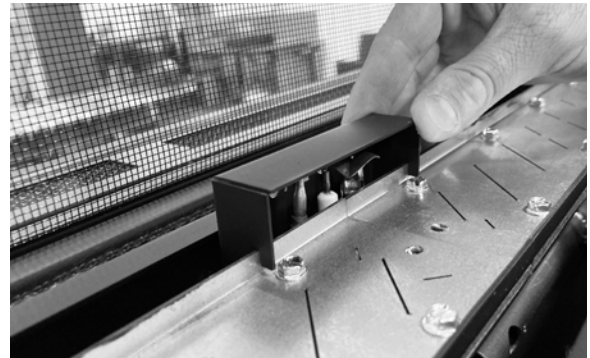

- Lift the end of each burner up and move towards the end of the firebox until the burner inlet tube is off of the burner orifice. Lift the burner out of the fireplace.

Note: The FORTY8 model fireplace only has one burner which is removed by lifting the burner to the right.



(continued on next page)

GAS CONVERSION

- Using a $\frac{1}{16}$ " deep socket remove and replace the burner orifices with correct orifice provided in the conversion kit.

Note: The FORTY8 model only has one burner orifice.

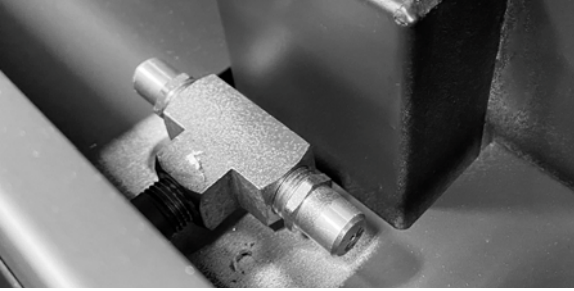

- When converting to propane, remove collar on burner inlet tube. When converting to natural gas install collar over burner inlet tube and secure with #8 sheet metal screw provided using a $\frac{1}{4}$ " nut driver.

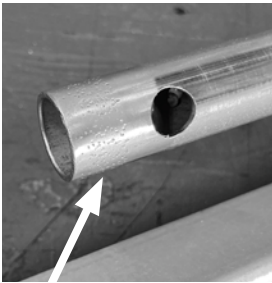

Collar OFF for LP

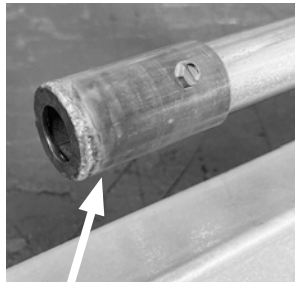

Collar ON for NG

- Remove the (2) #10 sheet metal screws using a $\frac{5}{16}$ " nut driver that hold the pilot assembly in the fireplace.



- Lift the pilot assembly into the fireplace which will give you access to the fittings under the pilot assembly. Take extra caution to not damage ceramic electrode on pilot assembly.

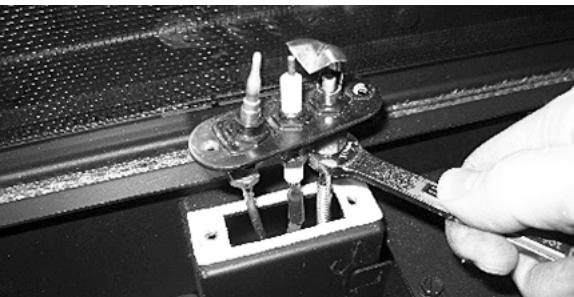

- Using a 10mm wrench, remove the pilot gas line and swap the pilot orifice with the one supplied in the conversion kit. Be sure that the pilot orifice is fully seated and the pilot gas line is tightened properly to prevent leaks around the orifice. If not seated properly this will cause an unusually high pilot flame.

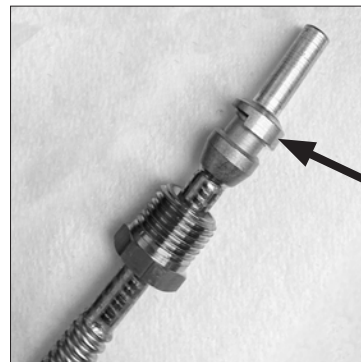

Pilot orifice correctly sealed

- Once the pilot gas line is tightened, reinstall the pilot assembly in the fireplace using the two #10 sheet metal screws provided. Ensure pilot gasket is intact.
- Reinstall the burners in the fireplace and the burner link (if required) with #10 sheet metal screws using a $\frac{5}{16}$ " nut driver.

(continued on next page)

GAS CONVERSION

GAS FLOW ADJUSTMENT

It is required you adjust the gas valve when converting the fireplace.

1. Locate and remove the pressure conversion brass plug and set it for NG or LP accordingly. Reinstall and tighten.

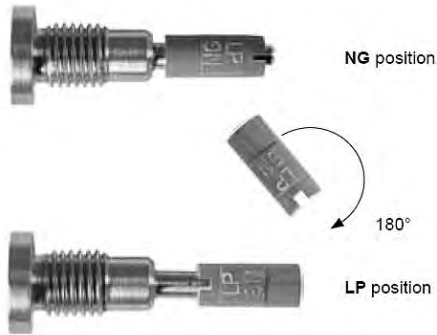

2. Locate and loosen the two 1/4" - 20 nuts under gas valve assembly in the front of the fireplace, using a 7/16" socket with 6" extension. To locate the second one it is necessary to swing the receiver module up to the left.



3. The entire gas valve assembly is on flexible connectors which allows you to lift it out of the fireplace as shown. Be sure all wires and gas lines are free when pulling gas valve assembly out of fireplace.

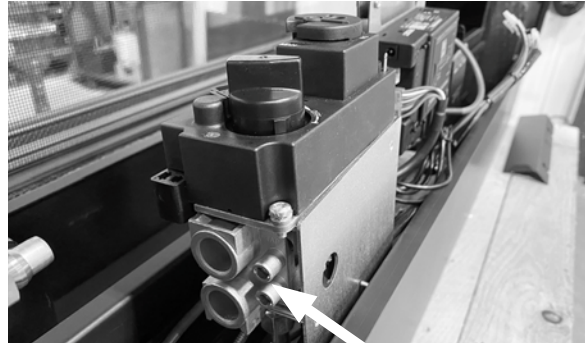

4. Confirm inlet pressure of gas (top pressure tap on valve) is between 5.5" w.c. to 10.0" w.c. for natural gas and 11" w.c. to 13" w.c. for propane. If pressure is not within these parameters, correct any gas supply pressure issue before continuing with conversion. Close the pressure tap.
5. Install a pressure gauge on the outlet pressure tap on the valve.
6. Light the fireplace using the remote control.
7. With the fireplace set on the highest flame level, set the high manifold pressure by adjusting the small flat screw set within the brass pressure conversion plug. Refer to the chart below for high pressure settings which vary per model fireplace.
8. With the fireplace set on the lowest flame level, set the low manifold pressure by adjusting the 4mm allen screw on the bottom side of the valve. Refer to the chart below for low manifold pressure settings which vary per model fireplace.

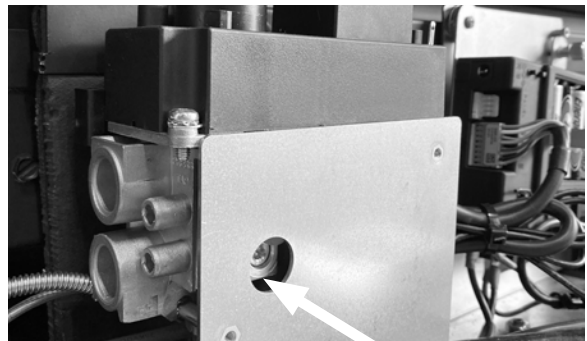

9. Ensure all pressure taps are closed and check all connections/pressure taps for leaks.

(continued on next page)

MANIFOLD PRESSURE SPECIFICATIONS

MODEL	HIGH MANIFOLD PRESSURE (NG)	LOW MANIFOLD PRESSURE (NG)	HIGH MANIFOLD PRESSURE (LPG)	LOW MANIFOLD PRESSURE (LPG)
FORTY8	3.9" w.c. / 1.0kPa	1.9" w.c. / 0.47kPa	10.0" w.c. / 2.5kPa	4.7" w.c. / 1.17kPa
SIXTY0	3.9" w.c. / 1.0kPa	1.9" w.c. / 0.47kPa	10.0" w.c. / 2.5kPa	4.7" w.c. / 1.17kPa
SEVENTY2	3.9" w.c. / 1.0kPa	2.2" w.c. / 0.55kPa	10.0" w.c. / 2.5kPa	4.7" w.c. / 1.17kPa

GAS CONVERSION

GAS CONVERSION LABEL INSTRUCTIONS

1. When converting this fireplace, use a permanent marker to complete the supplied gas conversion label then affix it to the floor of the fireplace, to the left of the Comfort Blower assembly.

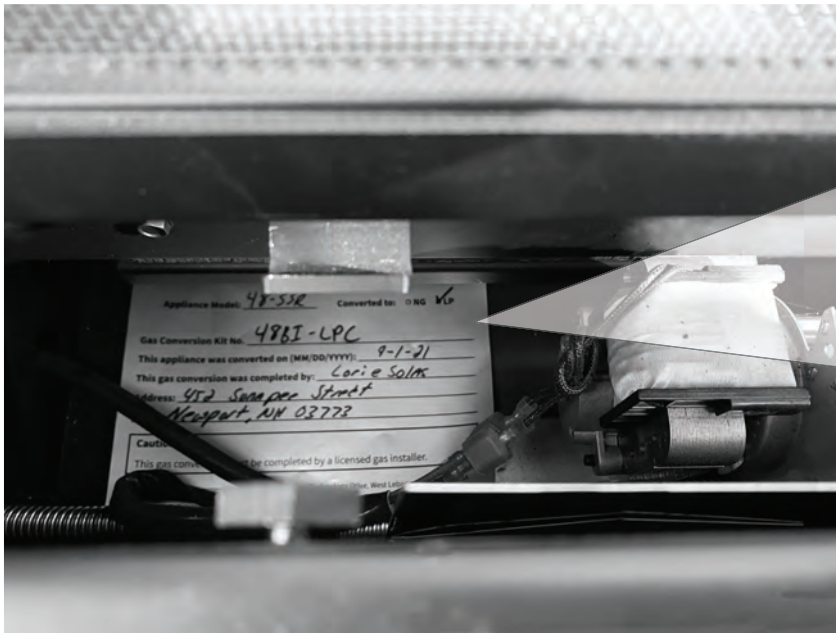

SÓLAS

This fireplace has been converted in the field. This label must be filled out with indelible ink and affixed in a conspicuous location near the appliance listing label.

Appliance Model: _____ Converted to: NG LP

Gas Conversion Kit No. _____

This appliance was converted on (MM/DD/YYYY): _____

This gas conversion was completed by: _____

Address: _____

Caution:
This gas conversion must be completed by a licensed gas installer.

2. Affix the supplied rating plate conversion label to the rating plate. Be sure to not cover the Model and Gas Pressure information for the model and fuel you are converting to. With a permanent marker, check off the fuel type you are converting to.

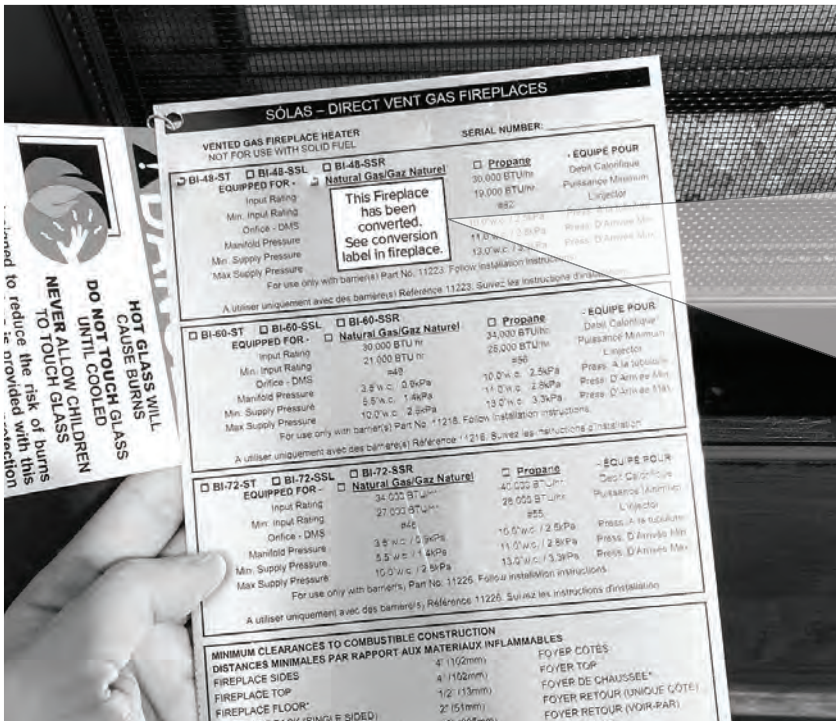

This Fireplace has been converted.

See conversion label in fireplace.

MAINTENANCE

ANNUAL MAINTENANCE

A qualified service agency should conduct an annual inspection and maintenance of your SÓLAS Gas Fireplace including the overall installation and venting to keep it running safely. The following procedures should be performed only by a qualified service technician. The gas supply should be turned off and the stove should be completely cool whenever a maintenance procedure is performed. All parts of the appliance that are removed for servicing must be replaced prior to operation.

This appliance should be inspected before use and at least annually by a qualified service technician. More frequent cleaning may be required due to excessive dust or lint from carpeting, bedding materials, pets, etc. It is imperative that control compartments and circulating air passageways of this appliance be kept clean.

CLEANING THE BURNER & FIREBOX

During the annual inspection and maintenance appointment, the service technician should clean the burner and firebox. To gain access to the firebox and burner, follow the instructions beginning on page 26 and 27 of this manual.

DO NOT USE A VACUUM CLEANER TO CLEAN THE GLASS BURNER MEDIA.

A vacuum cleaner may be used to clean the metal parts of the firebox. Leave the glass burner media in place. **Use a soft brush to clean the burner glass media.** If the burner media does need to be removed, carefully scoop it off the burner and avoid dropping glass pieces in the air gaps around the burner. Follow the instructions on pages 26 and 28 of this manual when replacing the burner media on the burner top.

AIR FLOW

The SÓLAS Gas Fireplace utilizes a convection air heat exchange system to maximize heat delivered from the fireplace. It is important that air flows freely through the convection air system and out the air grills. Do not place objects against the fireplace that will block the convection air inlet flow or in front of any air outlet.

CLEANING GLASS AND PORCELAIN ENAMEL PANELS

WARNING: Never clean the Glass or Enamel Panels while they are hot. Do not use abrasive cleaners or cleaners containing ammonia.

When the fireplace is first operated, there may be some vapors and a visible white film left on the glass and panels. This white film, a mineral deposit, is a normal by-product of the combustion process in a gas appliance. The composition of the deposit varies with location and time and is believed to be associated with varying sulfur content in the gas. You may experience this problem intermittently.

We have consulted with ceramic glass manufacturers and they cannot offer a definitive solution to the issue. The following are recommendations only and are not meant to guarantee results. NOTE: This is an issue beyond SÓLAS's control and is not covered under warranty.

- Clean the glass and porcelain enamel panels regularly as soon as you notice a white film build-up. If the film is left for a longer period of time it will etch into the glass and may be harder or impossible to remove.
- NEVER use an abrasive cleaner or an Ammonia-based cleaner on the ceramic glass. An abrasive cleaner will compromise the strength of the glass, An emulsion type cleaner is recommended.
- Use a damp, soft micro-fiber cloth or cotton cloth to apply the cleaner. Dry glass with a soft, dry cloth. (Paper towels and synthetic materials are abrasive to ceramic glass and should not be used)
- We have had good results from the following products, however we cannot guarantee results; Brasso, Polish Plus by Kel-kem, Cook Top Clean Creme by Elco, White Off by Rutland, Turtle Wax.
- **DO NOT CLEAN GLASS WHILE IT IS HOT!**

NOTE: The batteries in your SÓLAS One-Touch remote control and control module are to be replaced annually. Only use brand name alkaline batteries such as Duracell or Energizer.

BATTERY REPLACEMENT

CONTROL MODULE BATTERIES

Inside your fireplace, there are (4) AA batteries installed inside of the control module.

Frequent beeps for 3 seconds when the motor turns indicates the batteries inside the Control Module are low.

1. Remove air panel, left and right side panels and screen as shown on page 26.
2. Loosen silver thumb screw located on the top right side of the control module.



3. Slide the control module assembly up and to the left as shown.



4. The cover on the control module slides up, exposing the (4) AA batteries. Replace with (4) AA alkaline batteries. We recommend a name brand such as Duracell or Energizer.



5. Replace the battery cover, slide control module back into the fireplace and tighten silver thumb screw.
6. To reinstall the safety screen, reverse the steps on page 26.

SÓLAS ONE-TOUCH REMOTE BATTERIES

Your remote display will indicate when the batteries are low .

The remote uses a (2) AAA alkaline batteries—we recommend a name brand such as Duracell or Energizer.

The batteries should last one full season, depending on usage.

Remove the batteries in the off-season to extend battery life.



NOTE: Even though your fireplace is hardwired to 120V in your home, the batteries in your SÓLAS One-Touch remote control and control module are to be replaced annually. Only use brand name alkaline batteries such as Duracell or Energizer.

MAINTENANCE LOG

We strongly recommend that you keep a log of the regular maintenance that is performed on your SÓLAS fireplace. We have provided the maintenance form below to make it easy. Simply ask your qualified service technician to fill out one of the maintenance record forms below each time the fireplace is serviced. This will help insure that all of the required maintenance procedures have been completed, at least annually. Regular maintenance will help keep the fireplace functioning in a safe and reliable manner. Additional forms are available from your installer or service technician when needed.

Date of Service: _____

Serviced By: _____

Service Performed:

- Clean Burner & Firebox
- Clean Control Area
- Clean Convection Air System
- Leak Test Gas Connections
- Replace Batteries in Control Module & Remote
- Clean Firebox Panels and Glass
- Other_____

Date of Service: _____

Serviced By: _____

Service Performed:

- Clean Burner & Firebox
- Clean Control Area
- Clean Convection Air System
- Leak Test Gas Connections
- Replace Batteries in Control Module & Remote
- Clean Firebox Panels and Glass
- Other_____

Date of Service: _____

Serviced By: _____

Service Performed:

- Clean Burner & Firebox
- Clean Control Area
- Clean Convection Air System
- Leak Test Gas Connections
- Replace Batteries in Control Module & Remote
- Clean Firebox Panels and Glass
- Other_____

Date of Service: _____

Serviced By: _____

Service Performed:

- Clean Burner & Firebox
- Clean Control Area
- Clean Convection Air System
- Leak Test Gas Connections
- Replace Batteries in Control Module & Remote
- Clean Firebox Panels and Glass
- Other_____

Date of Service: _____

Serviced By: _____

Service Performed:

- Clean Burner & Firebox
- Clean Control Area
- Clean Convection Air System
- Leak Test Gas Connections
- Replace Batteries in Control Module & Remote
- Clean Firebox Panels and Glass
- Other_____

Date of Service: _____

Serviced By: _____

Service Performed:

- Clean Burner & Firebox
- Clean Control Area
- Clean Convection Air System
- Leak Test Gas Connections
- Replace Batteries in Control Module & Remote
- Clean Firebox Panels and Glass
- Other_____

REPLACEMENT PARTS LIST

GENERAL REPLACEMENT PARTS

PART NAME	P/N	PART NAME	P/N
Natural Gas (NG) Pilot Assy.	BI-401	TC Line Red	M46-701
Propane (LP) Pilot Assy.	BI-402	TC Line Yellow	M46-702
SÓLAS One-Touch Control Module	S-504	Thermocouple Interrupter Block	M46-703
Wall Touch Pad* (Optional)	WTP-1500	8-Wire Connecting Cable	M46-704
SÓLAS One-Touch Remote	S-507	Gas Valve (Maxitrol)	M46-515
Module for Additional Function	36-560	Comfort Blower	BI-BLOWER
See-Thru Firebox Side Panel	48ST-202	Single-Side Firebox Side Panel	48SS-202
Firebox Enamel Panel – Rear	48SS-201	Comfort Blower Wire Harness (Single Side)	48SS-561
Comfort Blower Wire Harness (See-Thru)	48ST-561	LH & RH Trim panel (1 set)	48BI-540

*Not Compatible with SÓLAS Self-Calibrating Power Vent Kit

FORTY8 – REPLACEMENT PARTS

PART NAME	P/N	PART NAME	P/N
#42 Burner Orifice (NG)	NGBI-48	Burner (NG)	48BI-301
#52 Burner Orifice (LP)	LPBI-48	Burner (LP)	48BI-302
Burner Glass Media (Clear/Mixed)	48BI-200	Burner Conversion Kit (NG)	48BI-NGC
Burner Conversion Kit (LP)	48BI-LPC	Lower Air Trim Panel	48BI-550

SIXTY0 – REPLACEMENT PARTS

PART NAME	P/N	PART NAME	P/N
#49 Burner Orifice (NG)	NGBI-60	Firebox Enamel Panel - End	60BI-201
#56 Burner Orifice (LP)	LPBI-60	Burner Module (NG) (2 req.)	60BI-301
Burner Glass Media (Clear/Mixed)	60BI-200	Burner Module (LP) (2 req.)	60BI-302
Burner Conversion Kit (NG)	60BI-NGC	Burner Conversion Kit (LP)	60BI-LPC
Lower Air Trim Panel	60BI-550		

SEVENTY2 – REPLACEMENT PARTS

PART NAME	P/N	PART NAME	P/N
#46 Burner Orifice (NG)	NGBI-72	Firebox Enamel Panel - Center	72BI-201
#55 Burner Orifice (LP)	LPBI-72	Burner Module (NG) (2 req.)	72BI-301
Burner Glass Media (Clear/Mixed)	72BI-200	Burner Module (LP) (2 req.)	72BI-302
Burner Conversion Kit (NG)	72BI-NGC	Burner Conversion Kit (LP)	72BI-LPC
Lower Air Trim Panel	72BI-550		

CONTROL SCHEMATIC

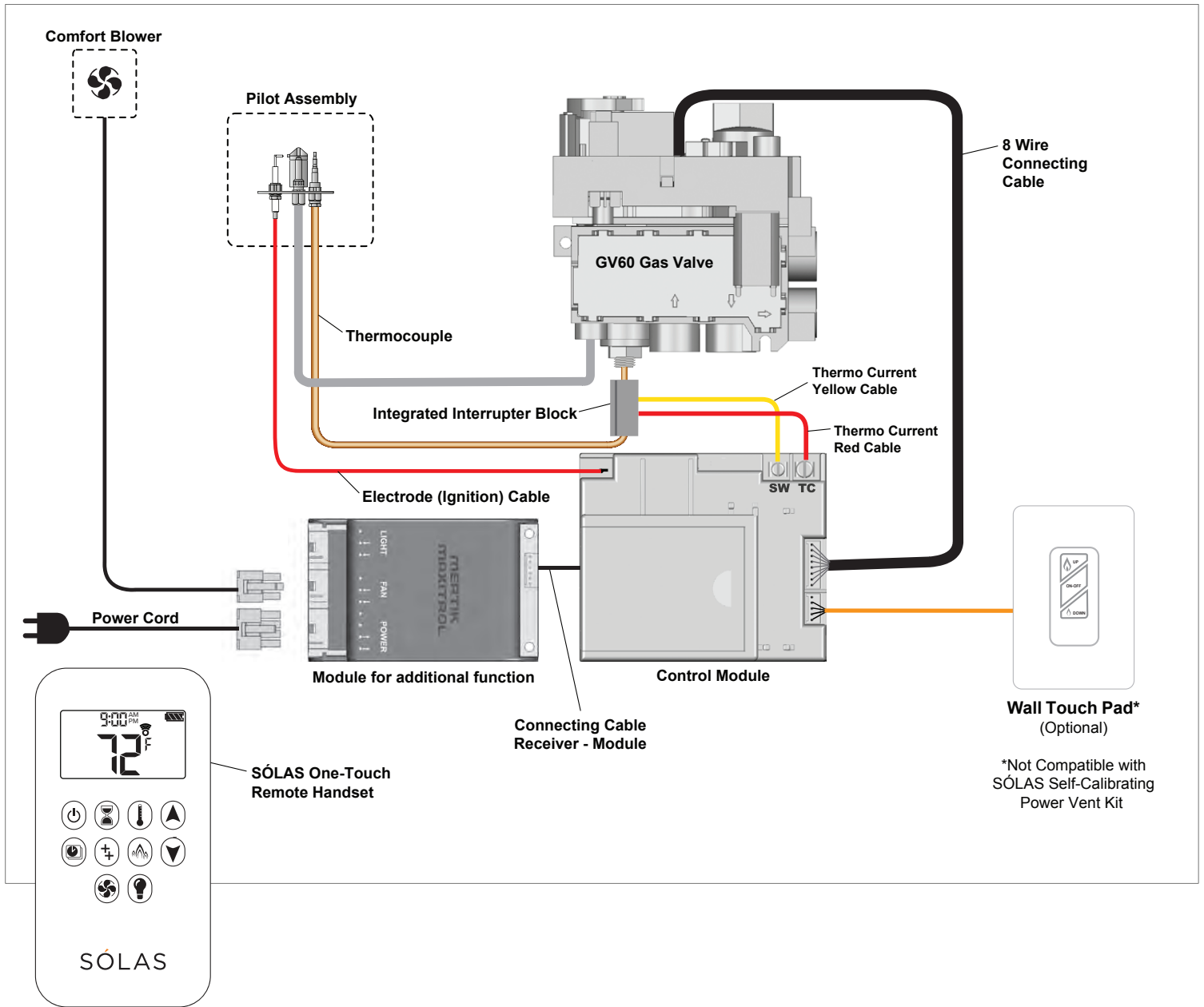

Caution

Label all wires prior to disconnection when servicing the controls. Wiring errors can cause improper and dangerous operation. Verify proper operation after servicing.

SÓLAS

For Replacement Parts and customer service, contact your SÓLAS Dealer or;

SÓLAS, LLC

452 Sunapee Street, Newport, NH 03773

P (603) 298-5169 sales@solasfires.com

WARRANTY INFORMATION

THE WARRANTY

SÓLAS, LLC, a division of Progressive Manufacturing, Inc. ("SÓLAS"), Limited Lifetime Warranty warrants your SÓLAS brand gas fireplace ("Product") to be free from defects in materials and workmanship at the time of manufacture. The Product body and firebox carry the Limited Lifetime Warranty on workmanship defects causing loss of structural integrity. Ceramic glass carries the Limited Lifetime Warranty against thermal breakage only. After installation, if covered components manufactured by SÓLAS are found to be defective in material or workmanship during the Limited Lifetime Warranty period and while the Product remains at the site of the original installation, SÓLAS will, at its option, repair or replace the covered components. If repair or replacement is not commercially practical, SÓLAS will, at its option, refund the purchase price or wholesale price of the SÓLAS product, whichever is applicable. SÓLAS will also pay their prevailing labor rates, as determined in its sole discretion, incurred in repairing or replacing such components during the warranty period. THERE ARE EXCLUSIONS AND LIMITATIONS to this Limited Lifetime Warranty as described herein.

COVERAGE COMMENCEMENT DATE

Warranty coverage begins on the date of installation. The warranty shall commence no later than 24 months following the date of product shipment from SÓLAS, regardless of the installation date.

EXCLUSIONS AND LIMITATIONS

This Limited Lifetime Warranty applies only if the Product is installed in the United States or Canada and only if operated and maintained in accordance with the printed instructions accompanying the Product and in compliance with all applicable installation and building codes and good trade practices.

This warranty is non-transferable and extends to the original owner only. The Product must be purchased through a listed supplier of SÓLAS and proof of purchase must be provided. The Product body and firebox carry the Limited Lifetime Warranty. The following do not carry the Limited Lifetime Warranty, but are warranted as follows:

- **Burner** – Repair or replacement for three years from date of installation.
- **Gas components & electrical components** – Repair or replacement for one year from date of installation.
- **Comfort Blowers & remote controls** – Repair or replacement for one year from the date of installation.
- **Porcelain Firebox Liners** – Replacement for one year against cracking or breakage due to thermal stress from date of installation. Excludes surface and hairline cracks and scratches or slight color changes that do not affect the operation or safety of the unit.
- **Gaskets** – Repair or replacement for one year from the date of installation.
- **Surrounds** – Replacement for one year against cracking or breakage due to thermal stress. Excludes surface and hairline cracks and scratches or slight color changes that do not affect the operation or safety of the unit.
- **Labor coverage** – Prevailing SÓLAS rates apply for the warranty period of the component. SÓLAS will not be liable for travel costs for service work.

SÓLAS will not be responsible for: (a) damages caused by normal wear and tear, accident, riot, fire, flood, or acts of God; (b) damages caused by abuse, negligence, misuse, or unauthorized alteration or repair of the Product affecting its stability or performance. The Product must be subjected to normal use. The product is designed to burn either natural or propane gas only. Burning conventional fuels such as wood, coal or any other solid fuel will cause damage to the Product, will produce excessive temperatures and could result in a fire hazard. (c) Damages caused by failing to provide proper maintenance and service in accordance with the instructions provided with the Product; (d) damages, repairs or inefficiency resulting from faulty installation or application of the Product.

Discoloration and some minor expansion, contraction, or movement of certain parts and resulting noise is normal and not a defect, and, therefore, not covered under warranty. The installer must ensure the appliance is burning as per the rating tag at the time of installation. Over-firing (operation above the listed BTU rate) of this appliance can cause serious damage and will nullify this warranty.

This warranty is void if:

- The unit has been operated in atmospheres contaminated by chlorine, fluorine or other damaging chemicals.
- The unit is subject to submersion in water or prolonged periods of dampness or condensation.
- Any damage to the unit, combustion chamber, heat exchanger or other components due to water or weather damage which is the result of, but not limited to improper chimney/venting installation.

Damage to stainless steel, gold, nickel or porcelain enameled surfaces caused by fingerprints, scratches, melted items, or other external sources left on these surfaces from the use of cleaners is not covered in this warranty.

SÓLAS is not responsible for inadequate fireplace system draft caused by air conditioning and heating systems, mechanical ventilation systems, or general construction conditions which may generate negative pressure in the room in which the appliance is installed. Additionally, SÓLAS assumes no responsibility for drafting conditions caused by venting configurations, adjoining trees or buildings, adverse wind conditions or unusual environmental factors and conditions that affect the operation of the unit.

This Limited Lifetime Warranty covers only parts and labor as provided herein. In no case shall SÓLAS be responsible for materials, components, or construction, which are not manufactured or supplied by SÓLAS or for the labor necessary to install, repair, or remove such materials, components, or construction. Additional utility bills incurred due to any malfunction or defect in equipment are not covered by this warranty. All replacement or repair components will be shipped F.O.B. from the nearest stocking SÓLAS facility.

LIMITATION ON LIABILITY

It is expressly agreed and understood that SÓLAS' sole obligation and the purchaser's exclusive remedy under this warranty, under any other warranty, expressed or implied, or in contract, tort or otherwise, shall be limited to replacement, repair, or refund, as specified herein.

In no event shall SÓLAS be liable for any incidental or consequential damages caused by defects in the Product, whether such damage occurs or is discovered before or after repair or replacement, and whether such damage is caused by SÓLAS' negligence. SÓLAS has not made and does not make any representation or warranty of fitness for a particular use or purpose, and there is no implied condition of fitness for a particular purpose.

SÓLAS makes no expressed warranties except as stated in this Limited Lifetime Warranty. The duration of any implied warranty is limited to the duration of this expressed warranty.

No one is authorized to change this Limited Lifetime Warranty or to create for SÓLAS any other obligation or liability in connection with the Product. Some states and provinces do not allow the exclusion or limitation of incidental or consequential damages, so the above limitations or exclusions may not apply to you. The provisions of this Limited Lifetime Warranty are in addition to and not a modification of or subtraction from any statutory warranties and other rights and remedies provided by law.

INVESTIGATION OF CLAIMS AGAINST WARRANTY

SÓLAS reserves the right to investigate any and all claims against this Limited Lifetime Warranty and to decide, in its sole discretion, upon the method of settlement.

To receive the benefits and advantages described in this Limited Lifetime Warranty, the appliance must be installed and repaired by a licensed contractor approved by SÓLAS.

Contact SÓLAS at the address provided herein to obtain a listing of approved dealers/distributors. SÓLAS shall in no event be responsible for any warranty work done by a contractor that is not approved without first obtaining SÓLAS' prior written consent.

HOW TO REGISTER A CLAIM AGAINST WARRANTY

In order for any claim under this warranty to be valid, you must contact the SÓLAS dealer/distributor from which you purchased the product. If you cannot locate the dealer/distributor, then you must notify SÓLAS in writing. SÓLAS must be notified of the claimed defect in writing within 90 days of the date of failure. Notices should be directed to the SÓLAS Warranty Department. Visit our website at www.solasfires.com/ warranty.

SÓLAS, LLC

P (603) 298-5169

F (603) 298-9246

solasfires.com/warranty

**NATIONAL
FIREPLACE
INSTITUTE**
**CERTIFIED**

We recommend that our gas hearth products be installed and serviced by professionals who are certified in the U.S. by the National Fireplace Institute® (NFI) as NFI Gas Specialists.
www.NFICertified.org

RECORD YOUR PRODUCT INFORMATION

Model #: _____ Serial Number: _____

Date Purchased: _____ Date Installed: _____

THANK YOU FOR CHOOSING
SÓLAS

solasfires.com

